

INSTALLATION INSTRUCTIONS



Ensure the area is prepared and ready for shade installation: Installation should never occur if the area is not fully complete. Additional installations such as wall paneling, pocket installations, painting and other types of finishes must be complete prior to shade installation. The area should be clean and free from dust and debris. We recommend cleaning the glass of the window prior to installation to ensure that no cleaning solutions will come into contact with the shade fabric. Wood blocking is required for all installations and should have been installed prior to finishing the walls.

Locate all necessary hardware and boxes: Brackets, bead stops, accessories, motor controls, power supplies, and other small items may be shipped in a separate box from the shades. Check the packing slip to locate the number of boxes received and ensure that all the hardware is present before beginning.

NOTE: CEILING POCKETS MUST BE INSTALLED PRIOR TO INSTALLING SHADES.
For instructions on Pocket installation see step 4. Accessory Installation.

Tools you will need to provide:

- Recommended screws: #10 or #12 Hex Head Screws. Jamb mount applications will require pan head screws
- Washers
- Electric screw driver/drill with appropriate tips
- Hand-held screw driver with Phillips head bit
- Measuring tape
- Level
- Combination Pliers
- Motorized Only - Programming tools (i.e. Motor Controls, Limit Setting Tools & Switches, etc.)
- Motorized Only - Wiring

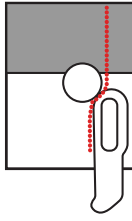
		WARNING
		ADVERTENCIA
Window Blind Cord Strangulation Risk Window blinds with a damaged or loose tension device or retractable cord that fails to fully retract pose a strangulation risk to children. To avoid this potential strangulation risk, consider purchasing cordless products or products with inaccessible cords.		Elimina el riesgo de estrangulamiento del cordón de la persiana Las persianas con dispositivos de tensión suelto, dañado o con un cordón retráctil cuyo mecanismo se encuentre deteriorado, representa un riesgo de estrangulación para los niños; por ello prefiere comprar productos con sistemas inalámbricos o con cordones de difícil acceso.

1. Identifying Mounting Type and Location

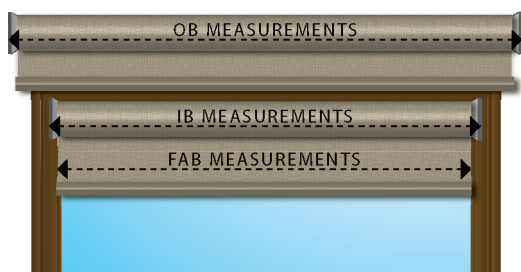

Before you begin, you must identify the proper shade positioning with regard to the frame. Shades ordered for Inside Bracket (IB) installations are for mounting inside of the window frame. Shades ordered for Outside Bracket (OB) installations are for mounting outside of the window frame. FAB shades should be treated as an OB installation.

WT Shade brackets come pre-set for your desired Mounting Location (Ceiling/Jamb or Wall Mount). If this needs to be changed, all SoloMount Brackets (and some pocket Brackets) can be adjusted by removing the screws at the base of the Mounting Flange, and the Mounting Flange can then be moved to the desired location. It can also be extended if you encounter an installation that requires you to move the fabric or roller away from the ceiling or wall.

IPC.3489/Rev.1

INSTALLATION INSTRUCTIONS

2. Installing the Brackets

IB Installations:

Using the window frame as a guide, determine the location you will be installing the first bracket. If you will be adding fascia (SoloMount style brackets only) be sure to leave enough room in front so the fascia will be flush with the surface outside the frame.

Using two screws, affix the bracket to the installation surface. Ensure the screws are secure. Follow the same process for the opposite side.

OB/FAB Installations:

To ensure proper coverage, locate the center line of the space in which you will be installing. Divide the FINISHED WIDTH of the shade in half and use this measurement to locate where you will install your first bracket.

Using two screws, affix the bracket to the installation surface. Ensure the screws are secure.

Measuring from the OUTSIDE FACE of the first bracket, affix the second bracket so that the distance between the OUTSIDE FACES of both brackets is equal to the FINISHED WIDTH of the shade. Use a level to ensure both brackets are even with each other and perpendicular to the floor.

Center Support Brackets:

Whether IB or OB installations, center support brackets should be installed so that from center line to center line between each bracket is equal to that of the FINISHED WIDTH of the shade band.

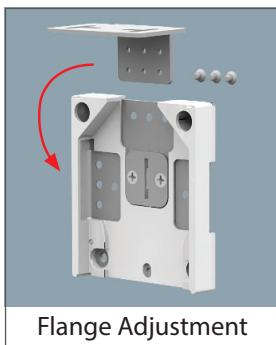

Flange Adjustment

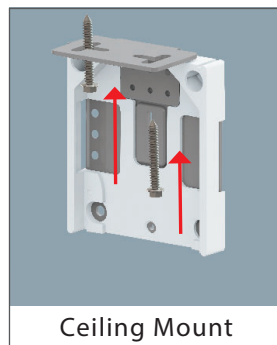

Ceiling Mount

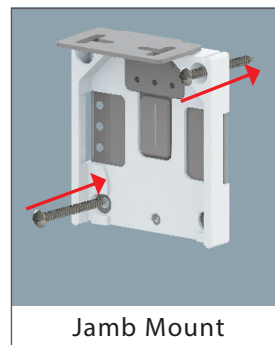

Jamb Mount

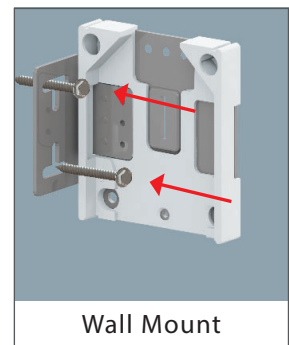

Wall Mount

PRO TIP

Before installing anything, determine whether your shade is Drive Right or Drive Left (location of the motor, spring or clutch) and identify each bracket in the pair. Be sure to install the correct bracket for each side of the shade.

Drive brackets

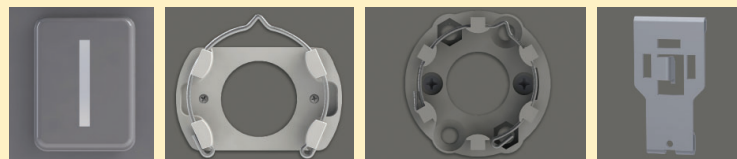

Idler brackets

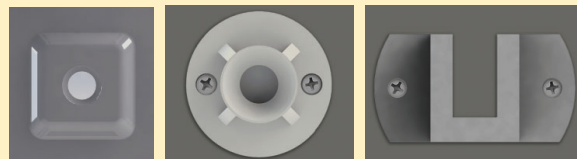

INSTALLATION INSTRUCTIONS

3. Mounting the Shade

For ALL Manual Clutch Shades: Begin at the idler end. Insert the idler pin into the center hole of the idler bracket. Using gentle pressure, depress the spring loaded idler by pressing against the bracket and bring the opposite side up and into alignment on the other side.

***For Coupled Shades:** When installing the next band, ensure that the shades will be properly placed by aligning the hembars. Insert the tang into the fork through the Center Support Bracket and continue the process as described for each band until you have reached the clutch end.

Ensure that the hook at the end of the clutch is seated properly in the slot. The chain should be running on either side of the set screw (as shown below-left). If not, simply unhook the clutch and adjust the chain.

***For Dual Shade systems:** Open the chain loop at the chain connector of the back/top shade, and thread it through the chain diverter at the bottom of the bracket. Reconnect the loop at the chain connector.

Secure the shade to the bracket by hand tightening the set screw at the bottom of the clutch. DO NOT USE A POWER TOOL TO DO THIS.

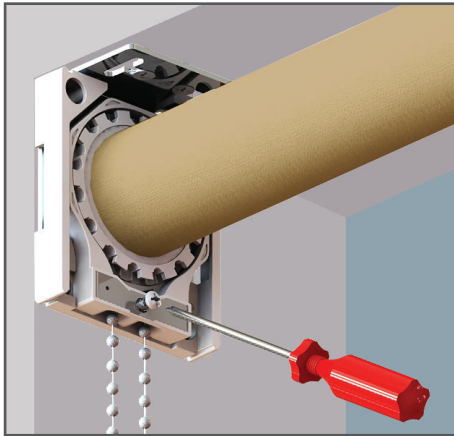

Child Safety Tension Device:

Pull the Child Safety Tension Device and depress slightly so it slides to the bottom of the chain loop. When installed properly, the chain should not be too tight that it hinders operation, should not be able to be pulled away from the wall any further than 6" and the chain connector should not be able to be opened without removing the Tension Device. Using two of the long screws,

included in the hardware box, install the Tension Device. It can be jamb, wall, or sill mounted. Select the best method of installation for your application type. Remove the paper sleeve from the shade band and discard.

To "set the limits"- Roll the shade to the "up" position. Identify the bead on the chain that is located just below the clutch. Wrap one of the matching Bead Stops, located in the hardware box, around the bead and squeeze it shut with pliers. Extend the shade to the "down" position and repeat this step on the other side of the chain.

Child Safety Chain Guard (Optional): The chain guard is pre-attached to the drive chain and hangs freely in the window. If Bead Stops will be used to set upper and lower limits, first determine if your shade is regular roll or reverse roll. For regular roll, adjust the shade to where you want to set the top limit. On the back side of the bead chain, mark the bead that is directly above the chain guard. Pull the shade down until you see the marked bead. Count down 7 beads from that marked bead and add your bead stop. Repeat for the bottom limit with the front side of the bead chain. For reverse roll, the front of the bead chain sets the upper limit, and the back of the bead chain sets the bottom limit.

Child Safety Tags to be removed by end user only

FOR SHADES WITH SPRING ASSIST MECHANISM (SAM)

If Clutch/SAM is removed from the tube, it may become unwound.

To rewind: Insert the spring into the tube, and spin the clutch. Recommended number of turns can be found on the printed label located on the tube.

RED SPRING

- Regular Roll, Drive Right
- Reverse Roll, Drive Left

Always tension by turning clutch counter clockwise.

GREEN SPRING:

- Regular Roll, Drive Left
- Reverse Roll, Drive Right

Always tension by turning clutch clockwise.

INSTALLATION INSTRUCTIONS

For ALL Manual Cordless Shades: Begin at the idler end. Insert the idler pin into the center hole of the idler bracket. Using gentle pressure, depress the spring loaded idler by pressing against the bracket and bring the opposite side (drive side) up and into alignment with the drive side bracket. Make sure the hooks on the drive end of the shade are facing down so they are able to hook onto the pre-attached adapter on the drive bracket.

After the shade is securely mounted to the brackets, you can remove the tension pin. Do not throw the tension pin away, it is used to lock in the proper spring tension if the shade ever needs to be removed from the window. Tip: tape the tension pin to the back side of the fascia if fascia is used. Shades come pre-tensioned, so once the tension pin is removed, check to make sure the tension is properly set. Move the bottom rail to multiple locations to ensure it doesn't creep up or slump down. Do this by pulling and pushing from the handle located on the center of the bottom rail. If the bottom rail slumps down when released, more tension is needed. If the bottom rail creeps up, then less tension is needed.

Adjusting Tension:

To adjust tension if needed, use the optional spanner tool or your hand. The drive end has indentations that the spanner tool hooks onto. For drive left regular roll, to add tension, rotate the drive end counter-clockwise (pulling spanner wrench down). To remove tension, rotate the drive end clockwise (pushing spanner wrench up). For drive right reverse roll, to add tension, rotate the drive end counter-clockwise (pushing spanner wrench up). To remove tension, rotate the drive end clockwise (pulling spanner wrench down).

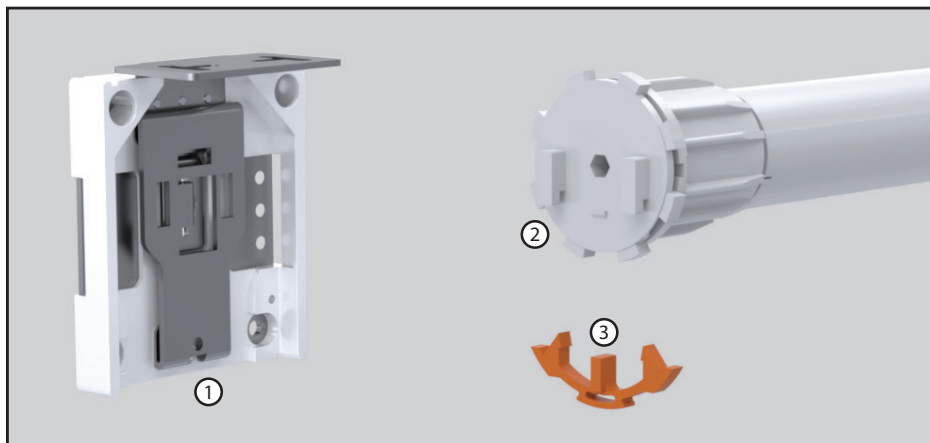

ITEMS

- 1 - Drive Bracket w/ Adapter
- 2 - Spring Drive End
- 3 - Tension Pin

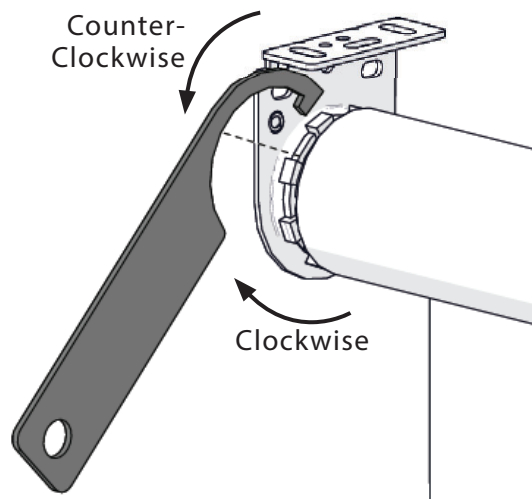

INSTALLATION INSTRUCTIONS

PRO TIP

Do not remove the paper sleeve from the shade bands until all shades have been installed. This will assist with aligning multiple shades in a space properly.

NOTE: ALL MOTORS REQUIRE PROGRAMMING

The following instructions are for physical motorized shade installation only and do not include information about motor programming, please contact WT Shade Customer Service.

For all Motorized MR150 systems: Begin at the idler end. Insert the idler pin into the center hole of the idler bracket. Using gentle pressure, depress the spring loaded idler by pressing against the bracket and bring the opposite side up and into alignment on the other side.

****For Coupled Shades:*** When installing the next band, ensure that the shades will be properly placed by aligning the hembars. Insert the tang into the fork through the Center Support Bracket and continue the process as described for each band until you have reached the motor end. Ensure that the hook at the end of the motor is seated properly in the slot.

For all Motorized MR250 systems: Remove the motor retainer ring from the drive side bracket before beginning, and set it aside for later.

Insert the idler pin into the center hole of the idler bracket. Using gentle pressure, depress the spring loaded idler by pressing against the bracket and bring the opposite side up and into alignment on the other side.

****For Coupled Shades:*** When installing the next band, ensure that the shades will be properly placed by aligning the hembars. Insert the tang into the fork through the Center Support Bracket and continue the process as described for each band until you have reached the motor end.

Make sure the motor power/communication cables are not in the way by making sure the power cable is threaded through the depressed area in the motor head.

Insert the star head of the motor into the motor retainer. Ensure the grooves along the edge of the motor head and along the edge of the motor retainer are in alignment, and reattach the motor retainer ring to hold the motor in place (as shown below). Remove the paper sleeve from the shade band and discard.

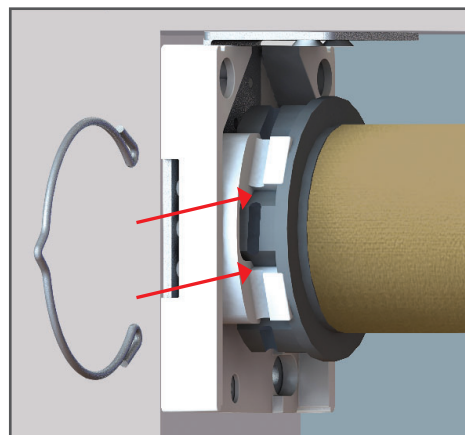

PRO TIP

Motors come in a variety of voltage types, lifting capacities and communication types. All motors must be programmed regardless of these variations, however the process for programming is different depending on which of these options you have selected for your shades. For more information about the initial programming and basic set-up, see the appropriate Basic Programming Instructions for your motor type.

INSTALLATION INSTRUCTIONS

4. Accessory Installation

Pocket Installation: Begin by ensuring that wood-blocking has been installed to support the weight of the pocket and shade.

Measure the area where the pocket is to be installed and cut down the pocket to the correct length. If the area exceeds 10' in length, you will need to join multiple pockets together using Splice Pins to align. Ensure that the Closure Hook is facing towards the correct direction (shades should roll away from the Bottom Closure).

Drilling directly through the pocket and into the surface of the mounting area, secure the pocket at 24"-30" intervals.

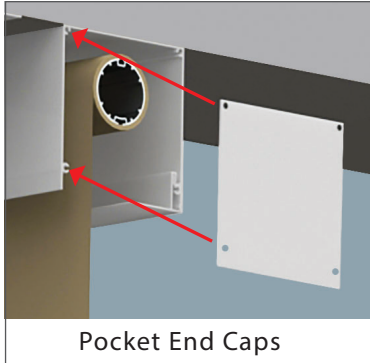

Pocket End Caps

***For CP55 & CP55TS pockets only:** For below ceiling installations, Pocket End Caps can be affixed to the end of the pocket using the included screws.

Closure Mount Installation: (For use with previously built gypsum or sheet-rock pockets.) Affix the Closure Mount to the surface parallel with the back of the shade. Ensure that the bottom of the Closure Mount is in line with the bottom of the build-in pocket. Secure to the mounting area at 24"-30" intervals.

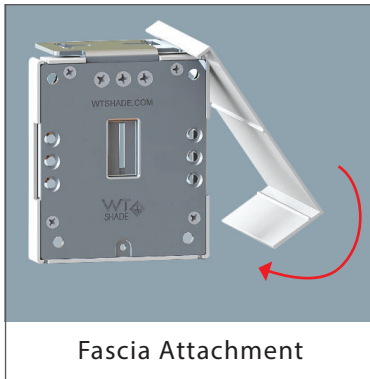

Fascia Attachment

Bottom Closure Installation: Bottom Closure should be installed AFTER the shading system has been mounted inside the pocket. Simply hook the Bottom Closure to the closure hook projection inside the pocket. Gently pull down to hook into place along the entire length.

Fascia Installation: Once the brackets have been installed and the shade has been mounted in place, locate the correct fascia for the shade. Hook the top of the fascia into the groove on the top of the bracket then press the bottom of the fascia to snap it into the groove at the bottom of the bracket. Sometimes the fit is tight and may require some force to snap in place.

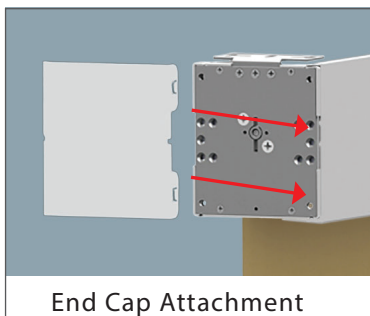

End Cap Attachment

To remove the fascia: Pull down on the bottom flap of front fascia to unhook and simply lift the fascia off of the bracket. If you are having trouble with this, or for removing rear fascia, you may be able to slide the fascia left or right to unhook from one of the brackets, making it easier to remove from the other.

End Cap Installation: If ordered, End Caps will be in the hardware box. These caps require no tools to install. Simply clip on to the end of the bracket. For applications with fascia, insert the tab of the end cap between the fascia and the bracket and press into place. Tabs can be bent slightly for a tighter fit.

Extendable Operating Wand: If ordered, the extendable operating wand will come with a wall mount clip. Using a #6 mounting screw, appropriate for the substrate, attach the mounting clip to the wall. Ensure the position of the mounting clip and operating wand do not interfere with the bottom rail or operation of the shade in general.

SHADING Accessories

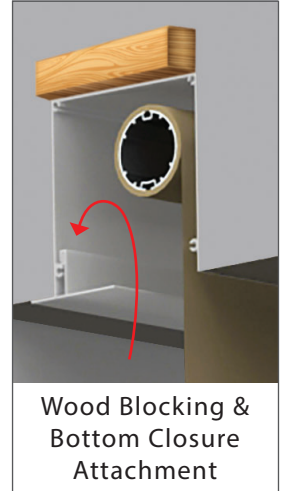

Wood Blocking &
Bottom Closure
Attachment

INSTALLATION INSTRUCTIONS

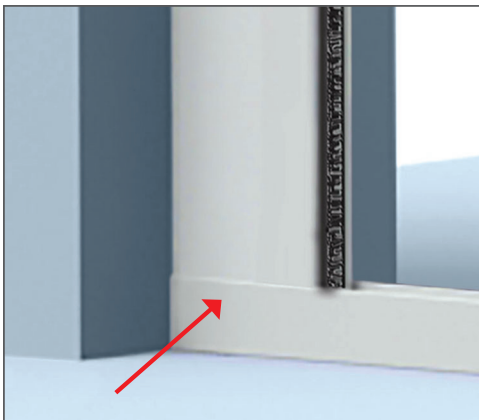

Side/Sill Channel Corner

Sill Channel Installation: *NOTE: if using sill channel with side/center channel, the sill channel MUST be installed first.*

Lower the shade so the hembar is touching the sill. Determine the best location for the sill channel by identifying where the hembar can come down inside without pulling. Affix to the sill using double sided tape or by drilling straight down through the channel into the sill. If using screws, make sure the screws are flush inside the channel so as not to interrupt the operation of the shade or damage the fabric.

Side & Center Channel Installation: *NOTE: if using side channel with sill channel, the sill channel MUST be installed first. Side/Center Channel should seat inside the sill channel when installed correctly. Side/Center Channel can be installed in a variety of ways using double sided tape or screws.*

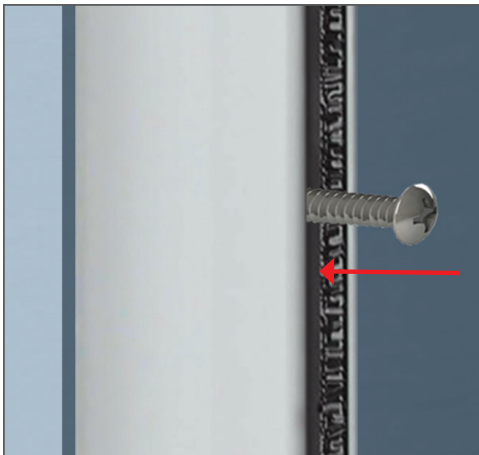

Jamb Mount

Jamb Mount Applications: Align the flat backside of the side channel with the back side of the bracket. If using screws, carefully insert the screw into the channel and secure to the window jamb through the back of the Side Channel (you may wish to pre-drill holes through the back of the channel). You must make sure the screws are flush inside the channel so as not to interrupt the operation of the shade or damage the fabric. If using tape, simply press the tape onto the back of the channel and press to affix to the wall. Once attached, slip the hembar into the top of the channel.

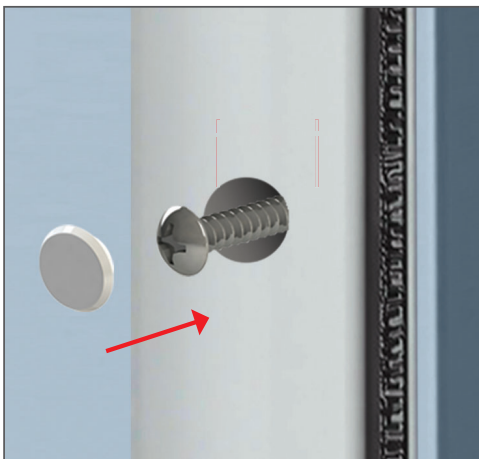

Surface Mount

Surface Mount Applications: Align the flat backside of the side channel with the back side of the bracket. If using screws, drill 1/2" holes into the front side of the side channel at equal spaces. **DO NOT DRILL HOLES THROUGH THE BACK WALL OF THE CHANNEL.** Carefully insert the screw into the channel through the holes and secure to the wall surface through the other side of the Side Channel (you may wish to pre-drill holes through the other side of the channel as well to make getting the screws through a little easier). Insert the color matching hole plugs into these 1/2" holes to finish. If using tape, simply press the tape onto the wall side of the channel and press to affix to the wall. Once attached, slip the hembar into the top of the channel.

INSTALLATION INSTRUCTIONS

Guide Track Installation:

Jamb Mount Applications: Align the flat backside of the side track with the back side of the bracket. Carefully insert the screw into the track and secure to the window jamb through the back of the Guide Track (you may wish to pre-drill holes through the back of the track). You must make sure the screws are flush inside the track so as not to interrupt the operation of the shade or damage the fabric. If using tape, simply press the tape onto the back of the track and press to affix to the wall. For external hembars, replace the standard end caps with the wheeled end caps and, slip the hembar into the top of the track.

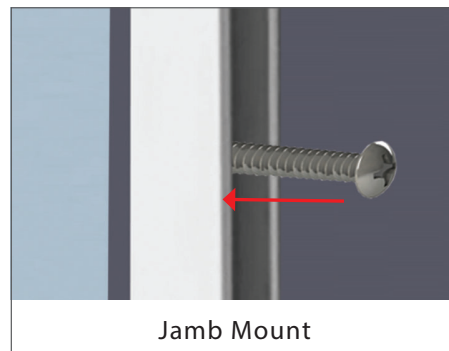

Surface Mount Applications: Align the flat backside of the guide track with the back side of the bracket. If using screws, drill 1/2" holes into the front side of the guide track at equal spaces. DO NOT DRILL HOLES THROUGH THE BACK WALL OF THE CHANNEL Carefully insert the screw into the track through the holes and secure to the wall surface through the other side of the track (you may wish to pre-drill holes through the other side of the track as well to make getting the screws through a little easier). Insert the color matching hole plugs into these 1/2" holes to finish. If using tape, simply press the tape onto the wall side of the track and press to affix to the wall. For external hembars, replace the standard end caps with the wheeled end caps provided in the hardware box and, slip the hembar into the top of the track.

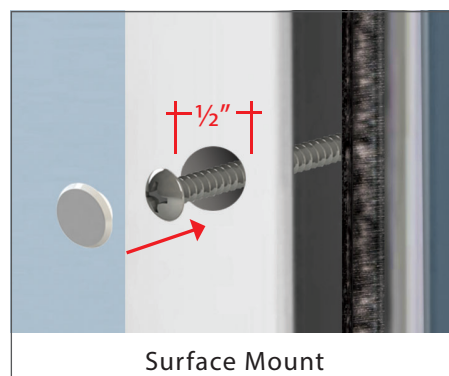

Guide Wire Cable Kit Installation:

Guide Cable Kits can be installed on either side of a shade or directly behind it. You may install as many kits as you feel are necessary on each shade. Determine how you wish to install the cables (wall or ceiling/jamb) and where you want them attached to the shade (side or back).

Unscrew the top and bottom of one of the larger barrels, and slip one end of the steel cable through the hole in the top. Secure the wire by crimping one of the studs to the end of the wire and clip off the excess wire (so that when the pieces are screwed back together, the crimp and end of the cable are on the INSIDE of the barrel).

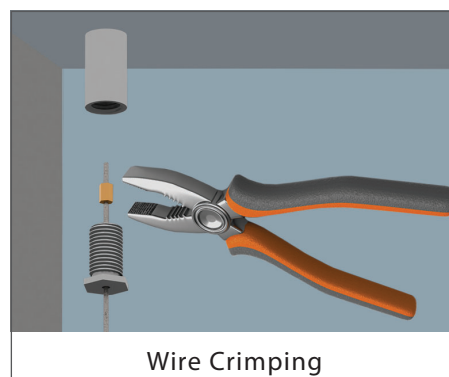

Install the bottom of the barrel either through the large hole in the bottom (ceiling/jamb mounts) or by installing the small angle to the wall and attaching the bottom of the barrel with a small screw (provided). Reattach the top and bottom of the barrel, only a little so that it is threaded but not tight. DO NOT TIGHTEN ALL THE WAY. You will need the extra space to tighten the cable later. Repeat this for the top of any other remaining cables you wish the use on the shade.

INSTALLATION INSTRUCTIONS

Guide Wire Cable Kit Installation (Continued):

If installing up the back of the shade, remove the end caps and slide the Cable clips into the groove on the back of the External Hembar. Secure in place using the attached set screw.

If installing down the side of the shade, remove the end caps and replace with the Guide Wire Cable End Caps (provided) and thread the wire through the channel in the cap.

Separate the tops and bottoms of the remaining barrels. Install to match the location of the top barrels (use a level to ensure they are parallel). Insert the cable through the top of the barrel and stretch the cable as much as you can to determine where to place the stud. Crimp and cut as previous. Screw the top of the barrel into the bottom barrel. Now tighten both the top and bottom barrels by screwing them together as tight as necessary to keep the wire very taut. Repeat for all the remaining barrels.

Idle Cable Support Kit Installation:

Idle Cable Support Kits can be installed horizontally across the width of a shade to lend support to sagging fabric in sloped or skylight applications. You may install as many kits as you feel are necessary.

Unscrew the top and bottom of one of the barrels, and slip one end of the steel cable through the hole in the top. Secure the wire by crimping one of the studs to the end of the wire and clip off the excess wire (so that when the pieces are screwed back together, the crimp and end of the cable are on the INSIDE of the barrel).

Install the bottom of the barrel either through the large hole in the bottom (jamb mounts) or by installing the small angle to the wall and attaching the bottom of the barrel with a small screw (provided). Reattach the top and bottom of the barrel, only a little so that it is threaded but not tight. DO NOT TIGHTEN ALL THE WAY. You will need the extra space to tighten the cable later.

Cut the Cable Sleeve to 2" shorter than the width of the shade, and slide the cable through the sleeve.

Separate the top and bottom of the remaining barrel. Install to match the height of the first barrel (use a level to ensure they are parallel). Insert the cable through the top of the barrel and stretch the cable as much as you can to determine where to place the stud. Crimp and cut as previous. Screw the top of the barrel into the bottom barrel. Now tighten both the top and bottom barrels by screwing them together as tight as necessary to keep the wire very taut.

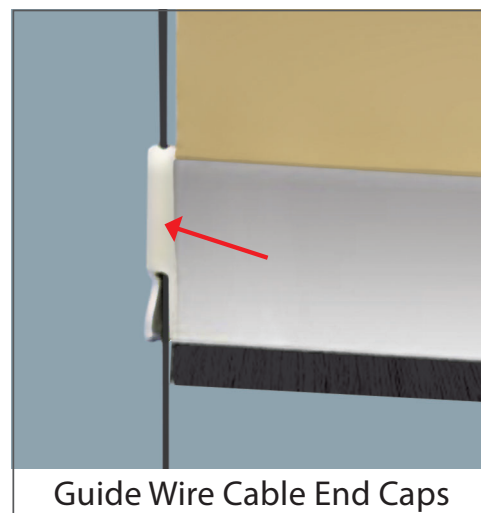

BASIC PROGRAMMING INSTRUCTIONS

Motors are shipped in FACTORY MODE without limit settings and are not assigned to any controls. These are very basic instructions that will allow you to program and set up an RTS motor. If you are looking for more advanced instruction or for instructions about specific motor accessories other than those mentioned here, please contact WT Shade Customer Service.

Follow these instructions for:



Before you Begin

Shades **MUST** be installed in brackets and connected to power prior to these steps. Do not attempt to program a motor that is laying on a table or is not inserted into a tube.

Power must **ONLY** be connected to the RTS window covering being programmed. All other window coverings must be disconnected from their respective power or put into sleep mode (ST30 Wirefree only) while programming.

While programming, motor should not be inactive for longer than 2 minutes or it will exit PROGRAMMING MODE.

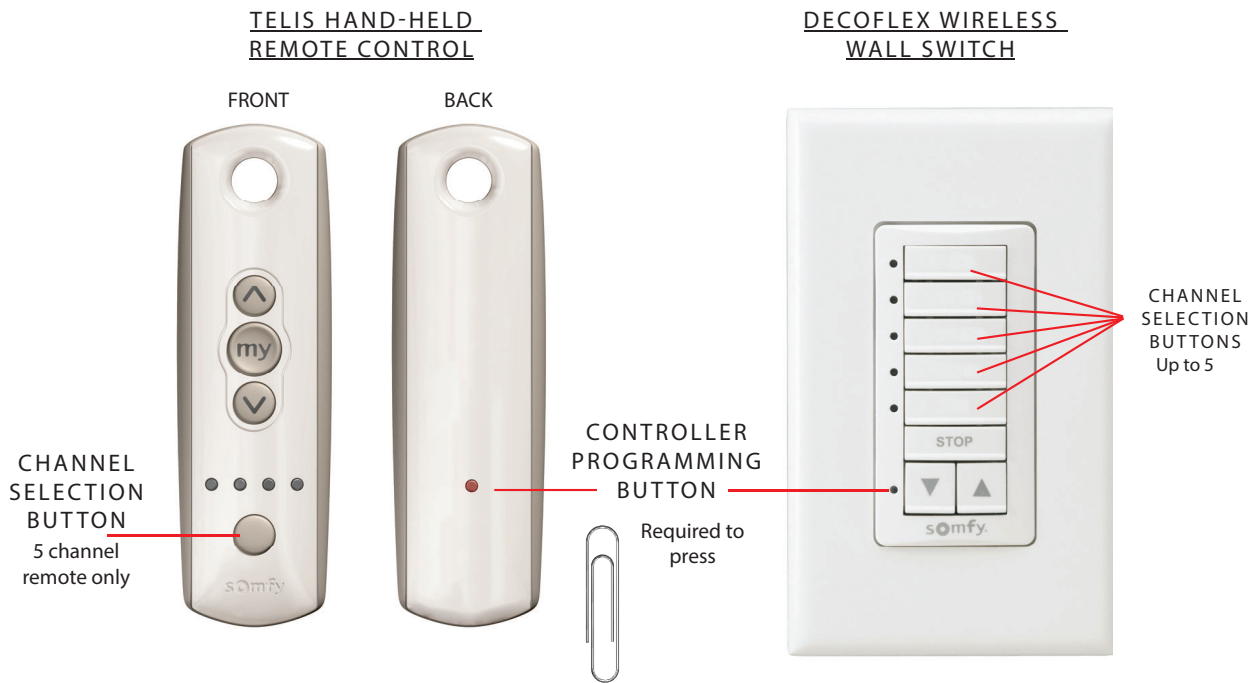

Tools you will need to provide:

- A remote control or wall switch
- A paper clip

For more advanced instructions than those given here, visit <https://WTShade.com/document-library/> to download the RTS Pocket Programming Guide.

SETTING MOTOR LIMITS

1. Use the Channel Selector Button to select one channel which will control the shade. You may add the shade to additional channels later.
2. PRESS and HOLD ▲ and ▼ at the same time until the shade jogs.
3. Check the direction of the motor: When you PRESS AND HOLD ▼ the shade should roll down. If it does not, you must reverse the motor direction. PRESS and HOLD MY/STOP until shade jogs.
4. Set the upper limit: Using the ▲, ▼, and MY/STOP buttons, bring the shade to the desired upper most limit (with the shade rolled all the way up). PRESS and HOLD ▼ and MY/STOP at the same time until the shade begins to move.
5. Set the bottom limit: Using the ▲, ▼, and MY/STOP buttons, bring the shade to the desired bottom most limit (with the shade unrolled all the way up). PRESS and HOLD ▲ and MY/STOP at the same time until the shade begins to move.
6. Confirm Limits: PRESS and HOLD MY/STOP until the shade jogs.
7. Complete Programming: PRESS and HOLD (For ST30 Wirefree only: TAP) the Controller Programming Button until shade jogs.
8. If you have more motors to program: Disconnect this motor from power and power up the next motor. Repeat these steps for all motors.

PRO TIP

A "jog" is a brief up and down motion, like a nod.

PRO TIP

If you must PRESS and HOLD ▲ or ▼ for the motor to move it is still in PROGRAMMING MODE. To put the motor into USER MODE, PRESS and HOLD the Programming Button until shade jogs.

ADJUSTING MOTOR LIMITS

NOTE: ONLY ADJUST ONE MOTOR AT A TIME. If more than one motor exists on a channel, you must power off the other motors on the channel.

1. Use the Channel Selector Button to select a channel that controls the shade you wish to adjust.
2. TAP ▲ or ▼ and allow the shade to stop at the current limit you wish to adjust.
3. PRESS and HOLD ▲ and ▼ at the same time until the shade jogs.
4. Using the ▲, ▼, and MY/STOP buttons, bring the shade to new position for the limit.
5. PRESS and HOLD MY/STOP to set the new position.
6. If you have more motors to adjust: Disconnect this motor from power and power up the next motor. Repeat these steps for all motors you wish to adjust.

ADDING MOTORS TO OTHER CHANNELS OR DEVICES

NOTE: When copying and pasting motors to other channels or other control devices, it is important to note that ALL motors on the channel will copy and paste IF CONNECTED TO POWER. If you only want to copy or paste one motor from a channel, you must power off the other motors on that channel.

1. Use the Channel Selector Button to select the channel that contains the motor or motors you want to “copy”.
2. PRESS and HOLD the Controller Programming Button until shade jogs.
3. Use the Channel Selector Button (on the same device or a new device) to select the channel you wish to “paste” the programming onto.
4. PRESS and HOLD (For ST30 Wirefree only: TAP) the Controller Programming Button until shade jogs.
5. Repeat steps 1-4 for each channel you wish to duplicate elsewhere.

To create an ALL Channel:

Follow steps 1-4 for each motor, ensuring that each motor is powered individually while copy/pasting. Select the same channel in step 3 for each motor. When all motors are powered back on, they will all be able to be controlled from this channel.

Copying from the motor itself (Low Voltage only):

If you have lost a controller, or wish to isolate a specific motor that is only included in a group channel, you can copy the motor directly by pressing the Motor Programming Button located on the motor head, for one jog, then follow steps 3-4 above to place it on a new channel.

To remove shade from a device or channel

To remove a shade, using the steps above isolate the shade onto a new channel other than the one you wish to delete it from. Copy this new channel and paste it BACK onto the channel you wish to remove it from. Pasting identical programming back onto itself will delete it.

SET/RESET INTERMEDIATE POSITION

1. Use the Channel Selector Button to select the channel that contains the motor or motors you wish to set an intermediate position for.
2. TAP ▲, ▼, and MY/STOP to bring the shade to the desired intermediate position.
3. PRESS and HOLD MY/STOP to set the new position.
4. Repeat these steps to reset the intermediate position as many times as desired.

NOTE: The intermediate position is stored in the motor and will be the set intermediate position for every channel it is programmed to.

RESETTING MOTORS TO FACTORY DEFAULT

Sometimes it's best to just start from scratch. Motor resetting varies from model to model. If you are not certain which motor you have, you can check the label located on the motor tube.

For Low Voltage Motors:

1. Locate the Motor Programming Button on the head of the motor (See Below).
2. PRESS and HOLD the Motor Programming Button until shade jogs 3 times consecutively.

Motor Programming Buttons for Low Voltage Motors

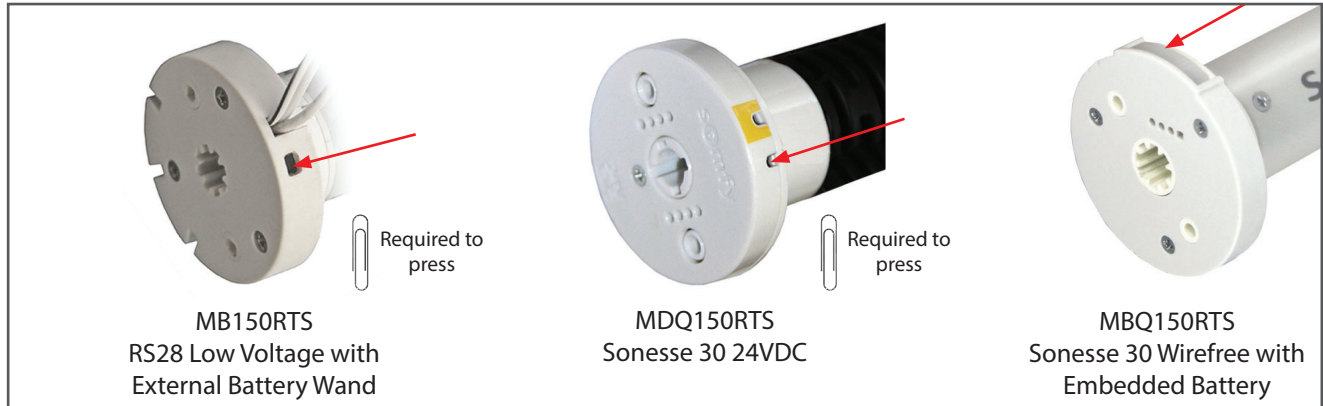

For Line Voltage Motors (Double Power Cut):

NOTE: You must be able to access both the power connection and a controller in order to properly reset the motor.

1. DISCONNECT the motor from power (unplug) for 2 seconds.
2. RECONNECT the motor to power (plug in) for 10 seconds.
3. DISCONNECT the motor from power (unplug) for 2 seconds.
4. RECONNECT the motor to power (plug in). Motor will begin to move.
5. When the shade stops moving, PRESS and HOLD the Controller Programming Button on any controller until shade jogs 2 times consecutively.

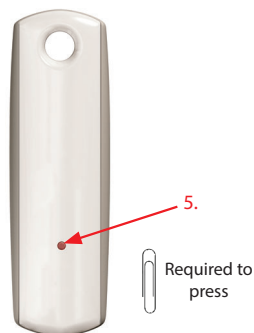
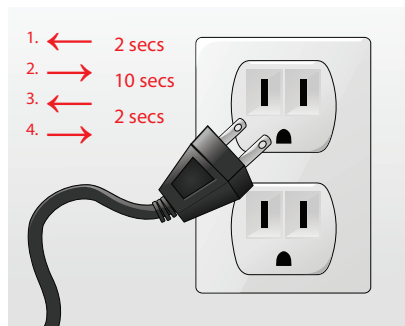

SLEEP MODE (ST 30 WIREFREE ONLY)

1. PRESS and HOLD the Motor Programming Button (located on the head of the motor) until shade jogs.
2. Briefly TAP the Motor Programming Button. The shade will jog twice indicating it has entered sleep mode.

To Awaken Motor:

1. Briefly TAP the Motor Programming Button. The shade will jog once to indicate it is now active.