

Installation Instructions

920 Internationally Compliant Handrail

Please read all instructions before installing handrail.

Important

1. Acclimate materials 24 hrs before installation. Maintain temperature controlled environment after installation.
2. Install in accordance with manufacturer's installation instructions. Failure to do so will void the warranty.

Installation tips

1. Cut covers up to 1/16" (1.6mm) longer to ensure a tight fit.
2. Lubricate blades when cutting aluminum to reduce burrs.

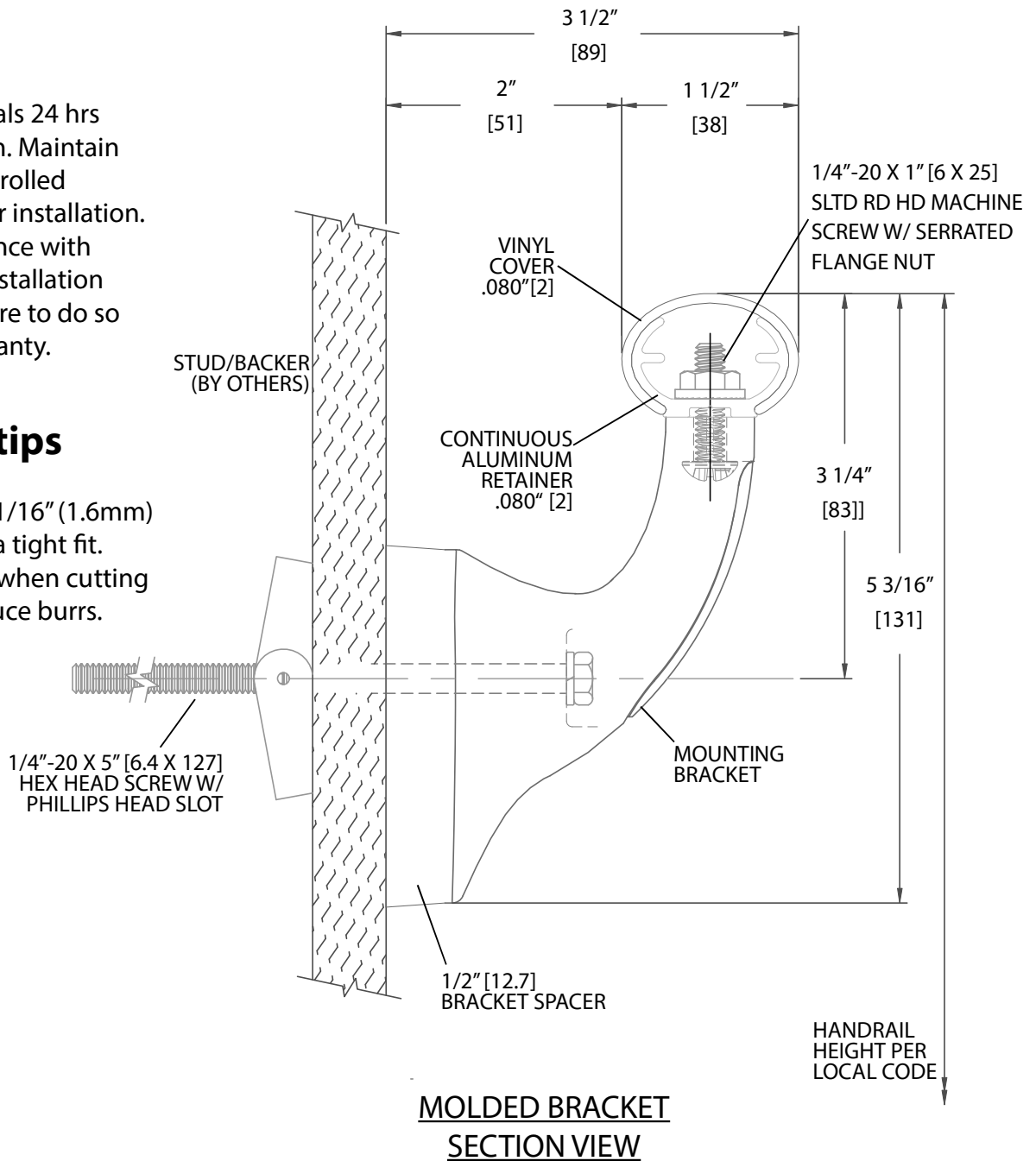

Recommended tools

Safety Glasses, Tape Measure, 3/8" socket for machine screw hex bolt, 7/16" socket for wood screw hex bolt, Level, Phillips and Flat head Screwdrivers, Power Drill, Drill Bits - 1/4" masonry (concrete/concrete block), Power Miter Saw, 10" Blade with 60-80 Carbide Tipped Teeth.

IPC.2133/REV.2

IPC® Door + Wall Protection

inpro.com • 800.222.5556 • 262.679.9010

World Headquarters S80 W18766 Apollo Drive, Muskego, WI 53150 USA

Installation Hotline: 866.394.6776

inpro®

Installation Instructions

920 Internationally Compliant Handrail

Please read all instructions before installing handrail.

Components and fasteners

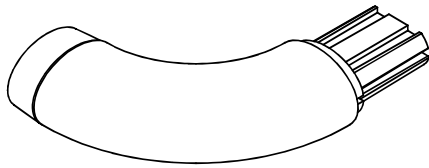

922SP
LEFT RETURN

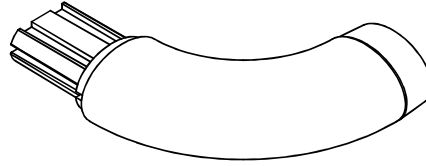

923SP
RIGHT RETURN

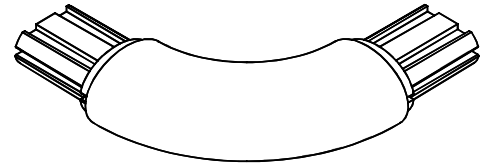

924
INSIDE/OUTSIDE CORNER

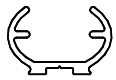

920A
CONTINUOUS
ALUMINUM RETAINER



920V
COVER

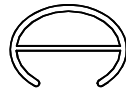

920 REVEAL
STANDARD ON
G2-920/920FV

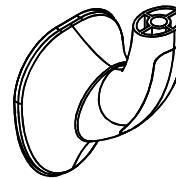

908
MOLDED BRACKET

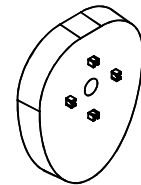

908SP
BRACKET SPACER



804-910-SPL
SPLICE



1/4-20
SERRATED
FLANGE NUT



1" SLOTTED
RD. HEAD SCREW



7/8" SLOTTED
PAN HEAD SCREW



#8 X 7/8" PHILLIPS
PAN SDS SCREW

Wall Conditions	Specified Fasteners	Inpro Part#
Drywall/Gypsum	1/4-20 x 5" Phillips Hex Head with lockwasher, toggle wing nut and 1/4-20 slotted round head bolt with flanged nut	HWK-908D
Concrete/Concrete Block	1/4"-20 x 5" Phillips hex head with lock washer and lead, 1/4-20 x 1" slotted round head bolt with flanged nut	HWK-908C
Wood/Gypsum	1/4" x 5" Hex head wood screw and 1/2"-20 x 1" slotted round head bolt with lockwasher and flanged nut	HWK-908W
OSHPD Drywall	1/4"-20 x 5" Phillips hex head bolt with Hilti Toggler, 1/4-20 x 1" slotted round bolt with lock washer and flanged nut	HWK-908OD
OSHPD Concrete	1/4" x 4" Torx Hex Washer head and 1/4-20 x 1" slotted round head bolt with flanged nut	HWK-908OC
OSHPD Wood	1/4" x 5" Hex head wood screw with 1/4-20 x 1" slotted round head bolt with lockwasher and flanged hex nut	HWK-908OW
Tech Screw	#14 X 4" Tek Screw, 1/4-20 x 1 1/8" slotted bolt, 1/4-20 x 1" slotted round head bolt with lockwasher and flanged nut	HWK-908S

IPC® Door + Wall Protection

inpro.com • 800.222.5556 • 262.679.9010

World Headquarters S80 W18766 Apollo Drive, Muskego, WI 53150 USA

Installation Hotline: 866.394.6776

inpro®

Installation Instructions

920 Internationally Compliant Handrail

Please read all instructions before installing handrail.

Layout Views

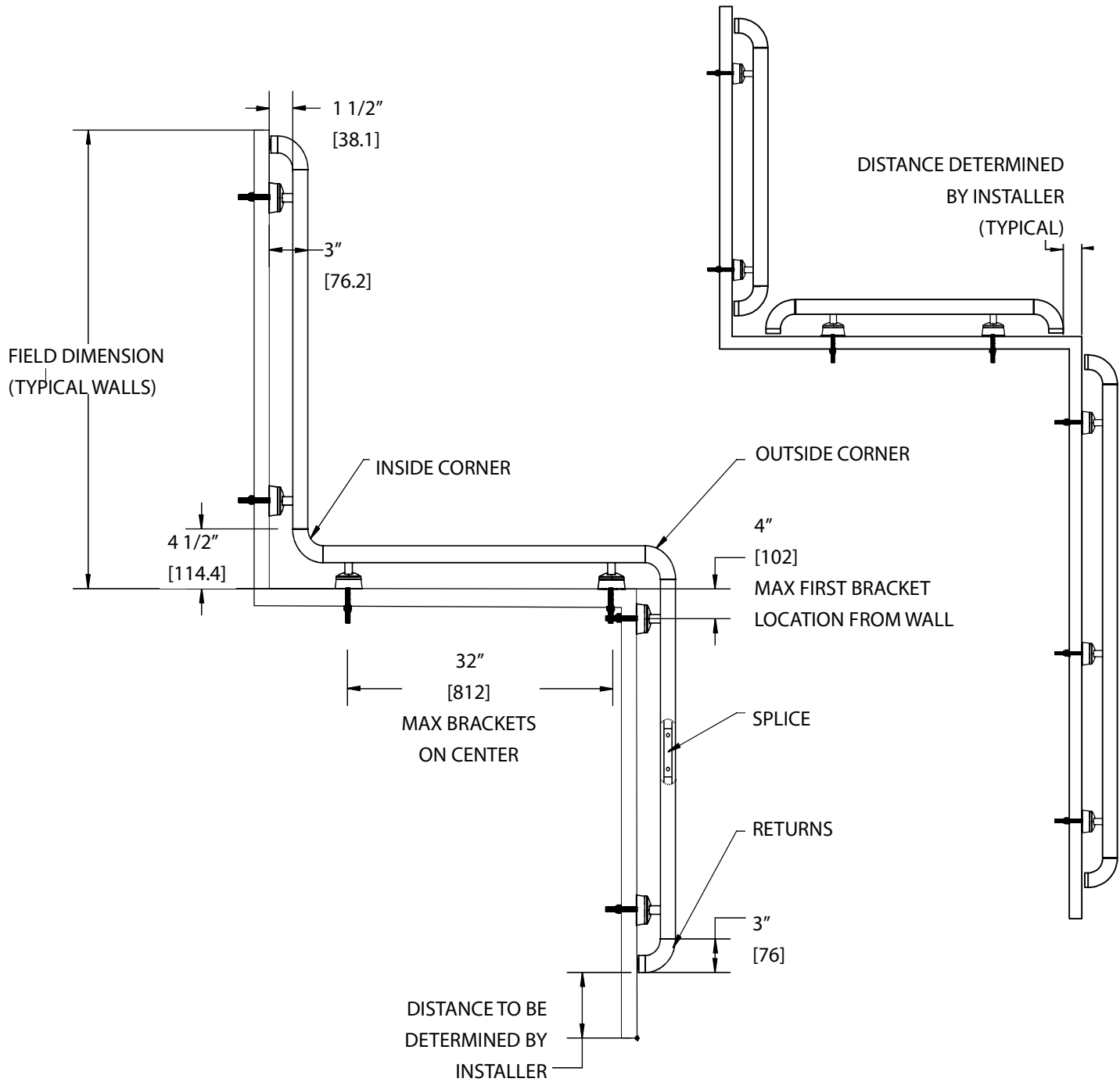

IPC® Door + Wall Protection

inpro.com • 800.222.5556 • 262.679.9010

World Headquarters S80 W18766 Apollo Drive, Muskego, WI 53150 USA

Installation Hotline: 866.394.6776

inpro®

Installation Instructions

920 Internationally Compliant Handrail

Please read all instructions before installing handrail.

Exploded View Assembly

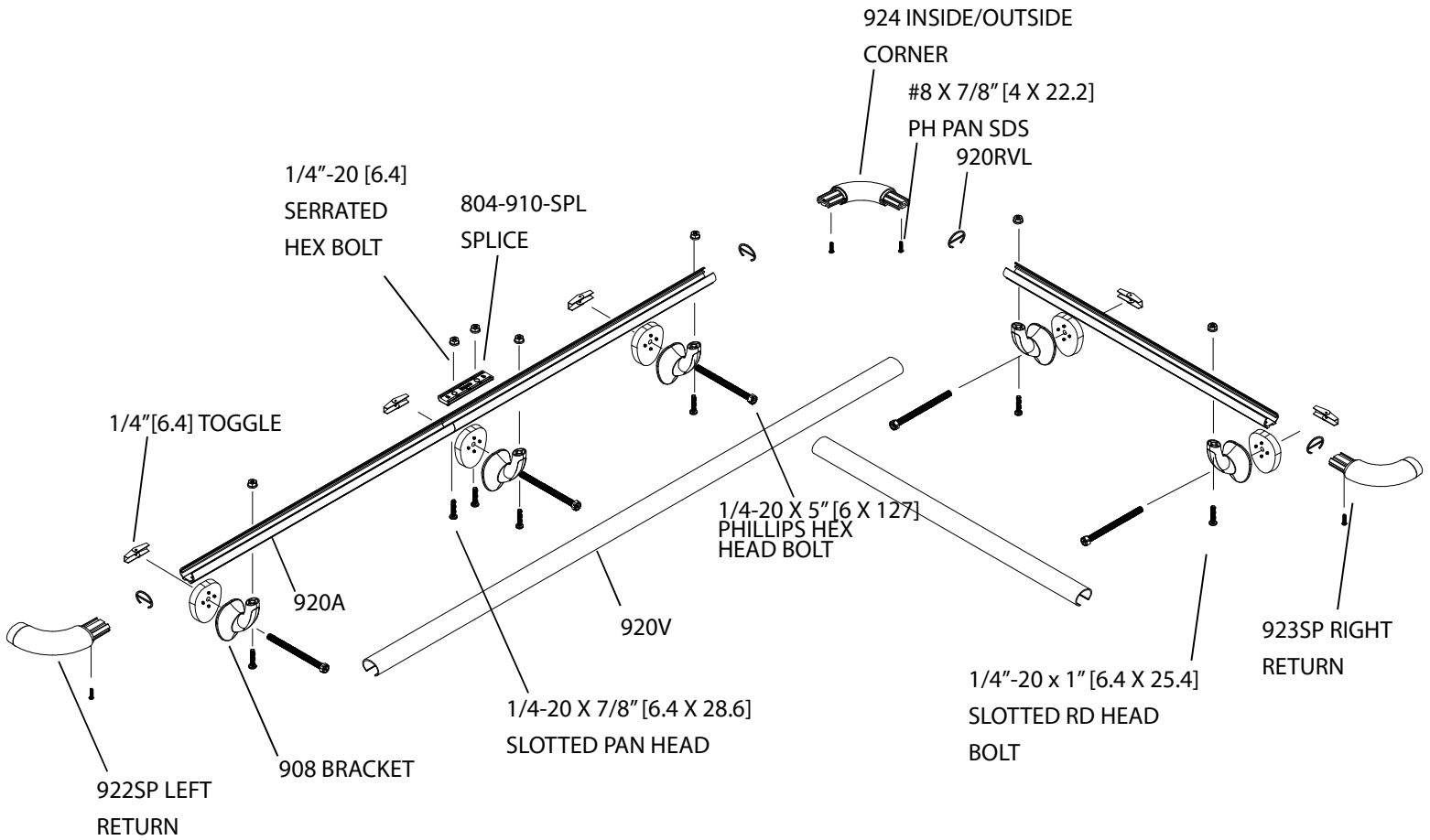

IPC® Door + Wall Protection

inpro.com • 800.222.5556 • 262.679.9010

World Headquarters S80 W18766 Apollo Drive, Muskego, WI 53150 USA

Installation Hotline: 866.394.6776

inpro®

Installation Instructions

920 Internationally Compliant Handrail

Please read all instructions before installing handrail.

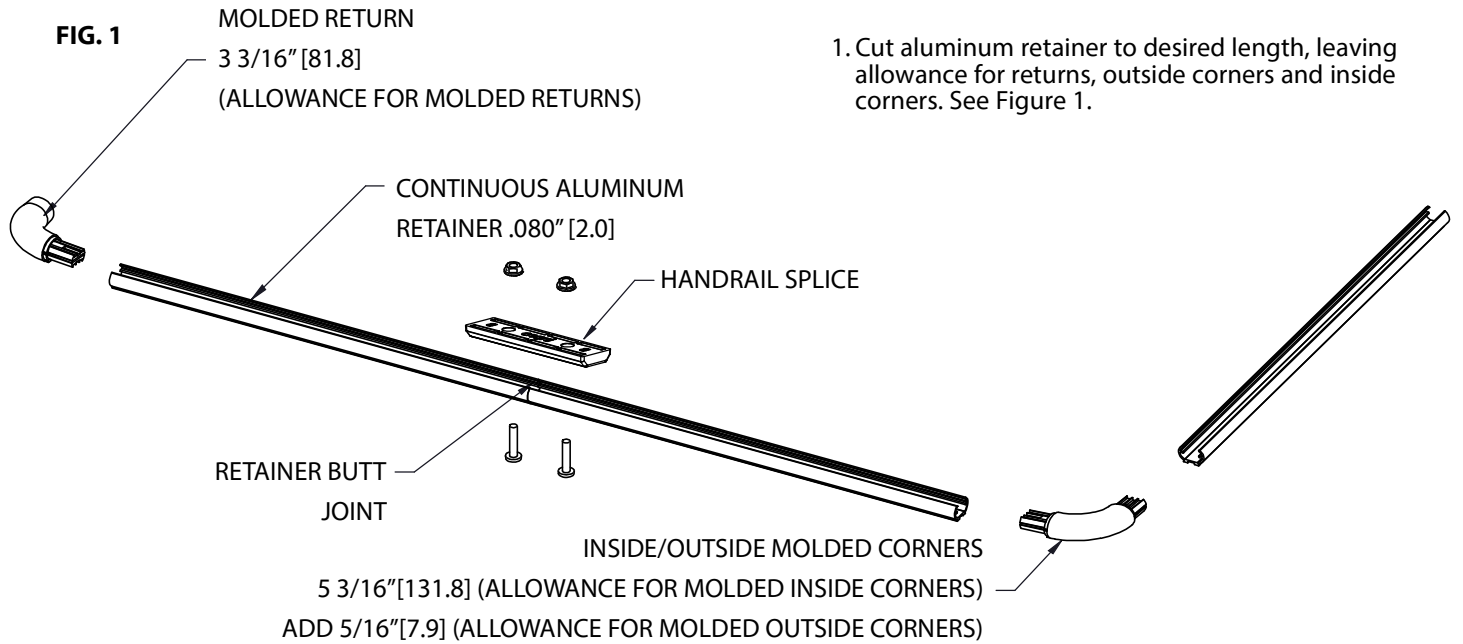

1. Cut aluminum retainer to desired length, leaving allowance for returns, outside corners and inside corners. See Figure 1.

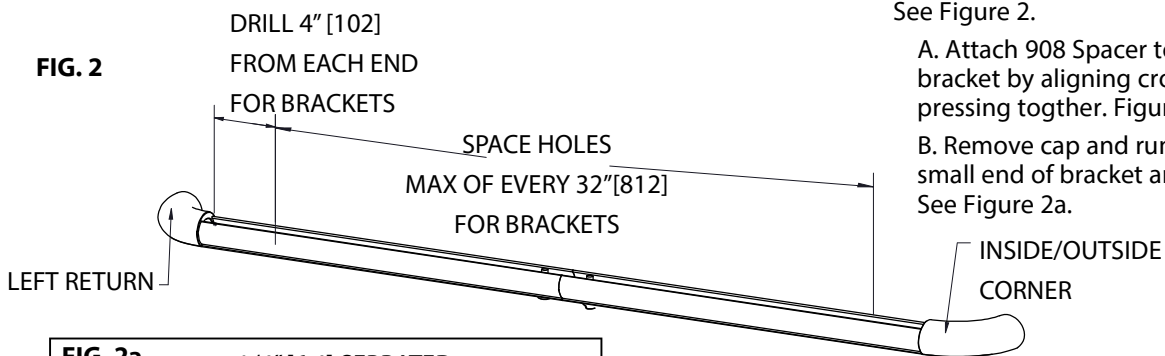

2. Drill holes in centerline of aluminum retainer for brackets and splices using a 1/4" (6mm) drill bit. Attach returns, inside corners and outside corners to retainer.

See Figure 2.

A. Attach 908 Spacer to back of 908 molded bracket by aligning crosshairs with clips and pressing together. Figure 2a.

B. Remove cap and run 1" [25.4] bolt up through small end of bracket and retainer hole to attach. See Figure 2a.

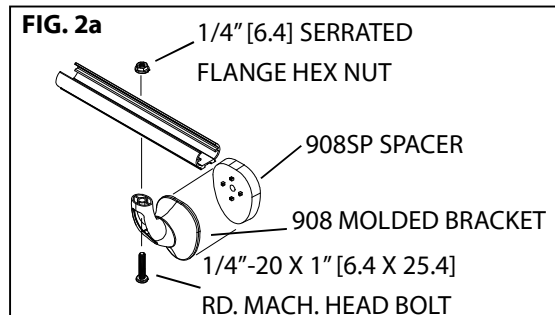

IPC® Door + Wall Protection

inpro.com • 800.222.5556 • 262.679.9010

World Headquarters S80 W18766 Apollo Drive, Muskego, WI 53150 USA

Installation Hotline: 866.394.6776

inpro®

Installation Instructions

920 Internationally Compliant Handrail

Please read all instructions before installing handrail.

FIG. 3a

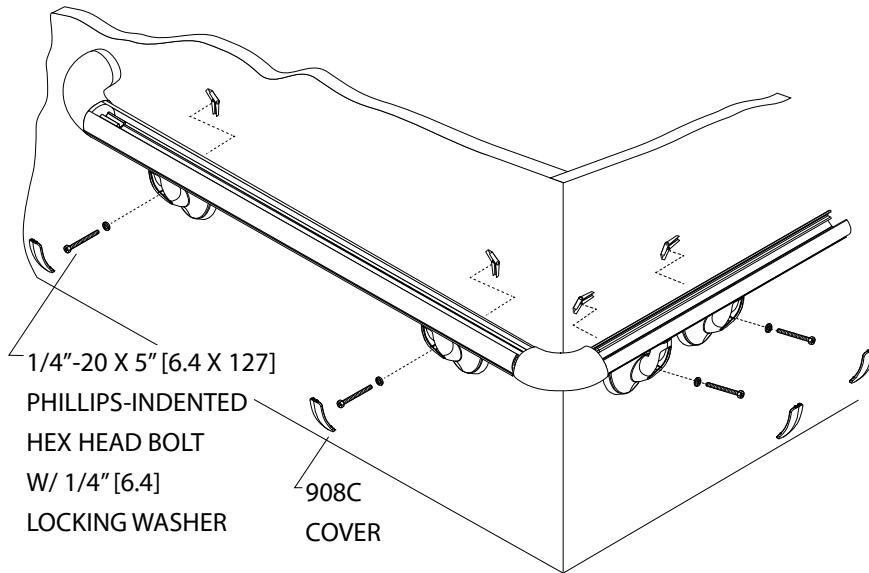

3. Position retainer against wall at desired height. Level and mark bracket holes on wall. Drill marked holes with 3/4" [19mm] drill bit for toggle bolts (drywall installation) or 1/2" [13mm] drill bit for lead anchor (concrete wall installation). Loosely attach mounting bolts to the brackets. Mount on wall, level retainer and tighten screws to secure. Snap 908C cover on to bracket. See Figure 3a.

NOTE: For stainless steel bracket, snap cover over mounting base when retainer is secure. See Figure 3b.

- 3a. For long runs of handrail, secure each section of aluminum retainer to the next with the supplied splice piece.

NOTE: Make sure you install the splice with side "B" facing up.

FIG. 4

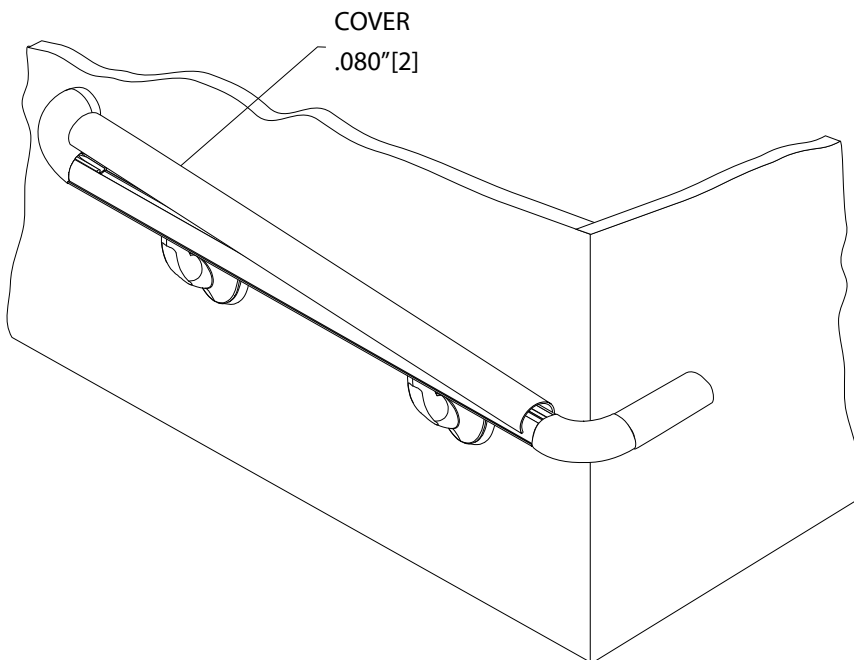

4. Cut cover to length between returns and/or corners. (Note: Trim factory edges square before installation). Position cover on retainer at one end and work to the other end by snapping the cover over the retainer. See Figure 4.

IPC® Door + Wall Protection

inpro.com • 800.222.5556 • 262.679.9010

World Headquarters S80 W18766 Apollo Drive, Muskego, WI 53150 USA

Installation Hotline: 866.394.6776

inpro®