

# Installation Instructions

## Joint System: 650C-A07 Wall to Wall

**Note: Verify that the structural gap is in conformance with submittal data before beginning installation. If this is a Fire Rated Assembly, install the fire barrier before the Architectural Joint System. Refer to the fire barrier instructions for specific system installation. See Reinforced Vapor Barrier Installs (IPC.1698) for proper installation procedures. Available on inprocorp.com under Fire + Moisture Barriers.**

### Wall to Wall Detail

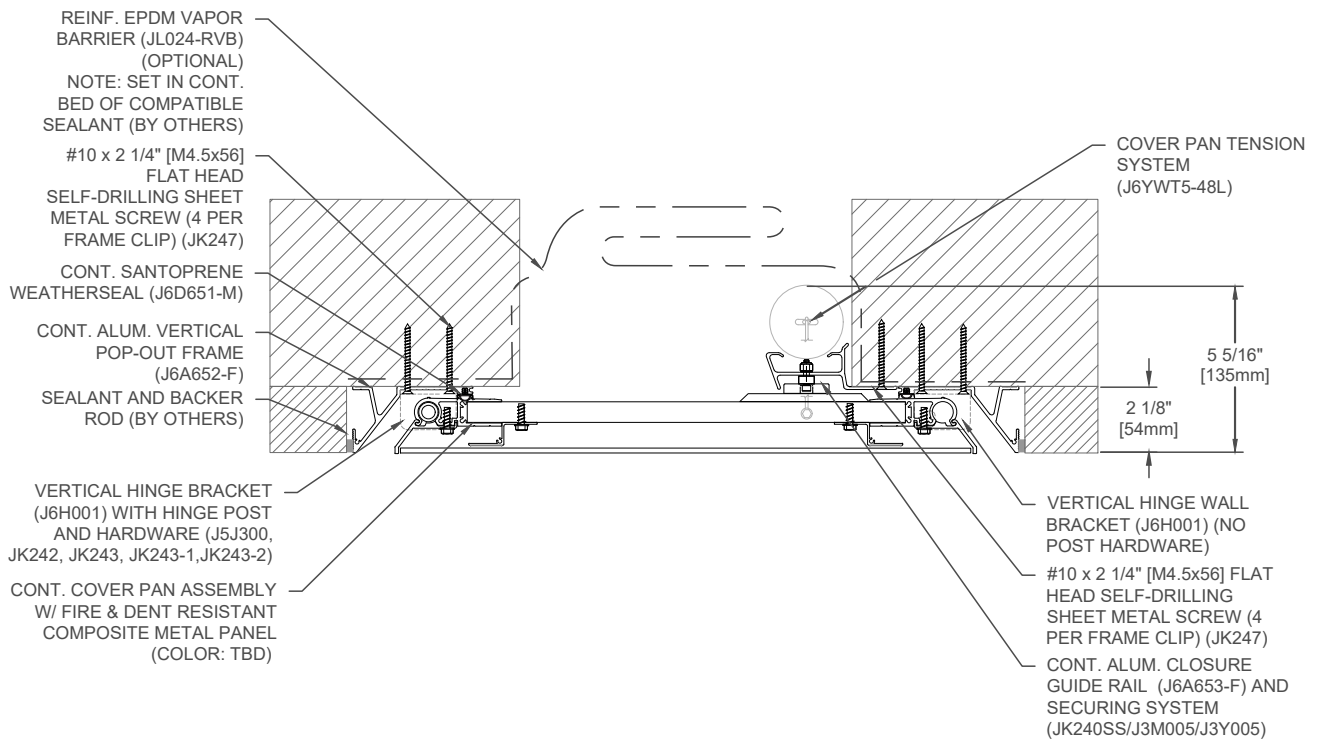

### Detail:

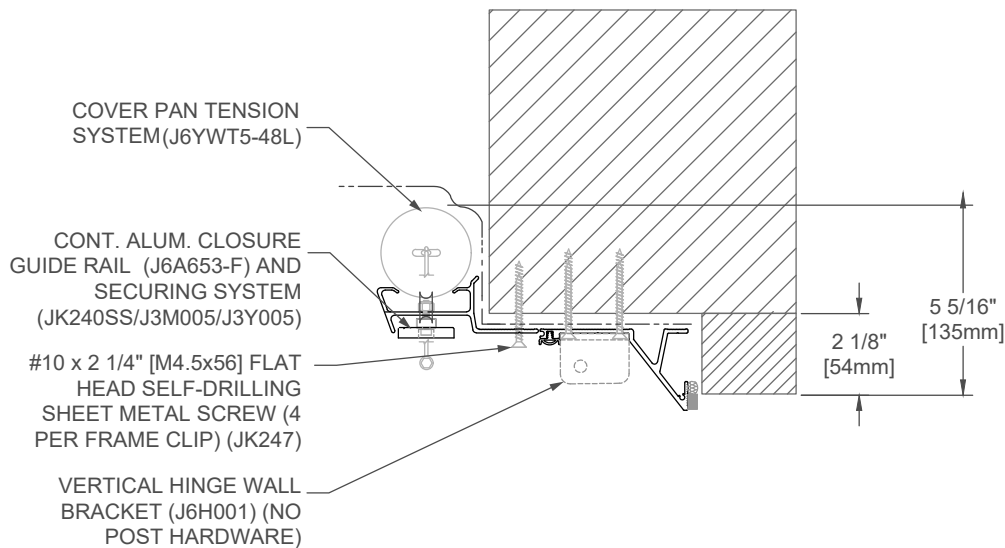

IPC.3541/REV.2

JOINTMASTER® Expansion Joint Systems

inpro.com • 800.222.5556 • 262.679.9010

World Headquarters S80 W18766 Apollo Drive, Muskego, WI 53150 USA

Installation Hotline: 866.394.6776

**inpro**®

# Installation Instructions

Joint System: 650C-A07 Wall to Wall

## Assembly Overview:

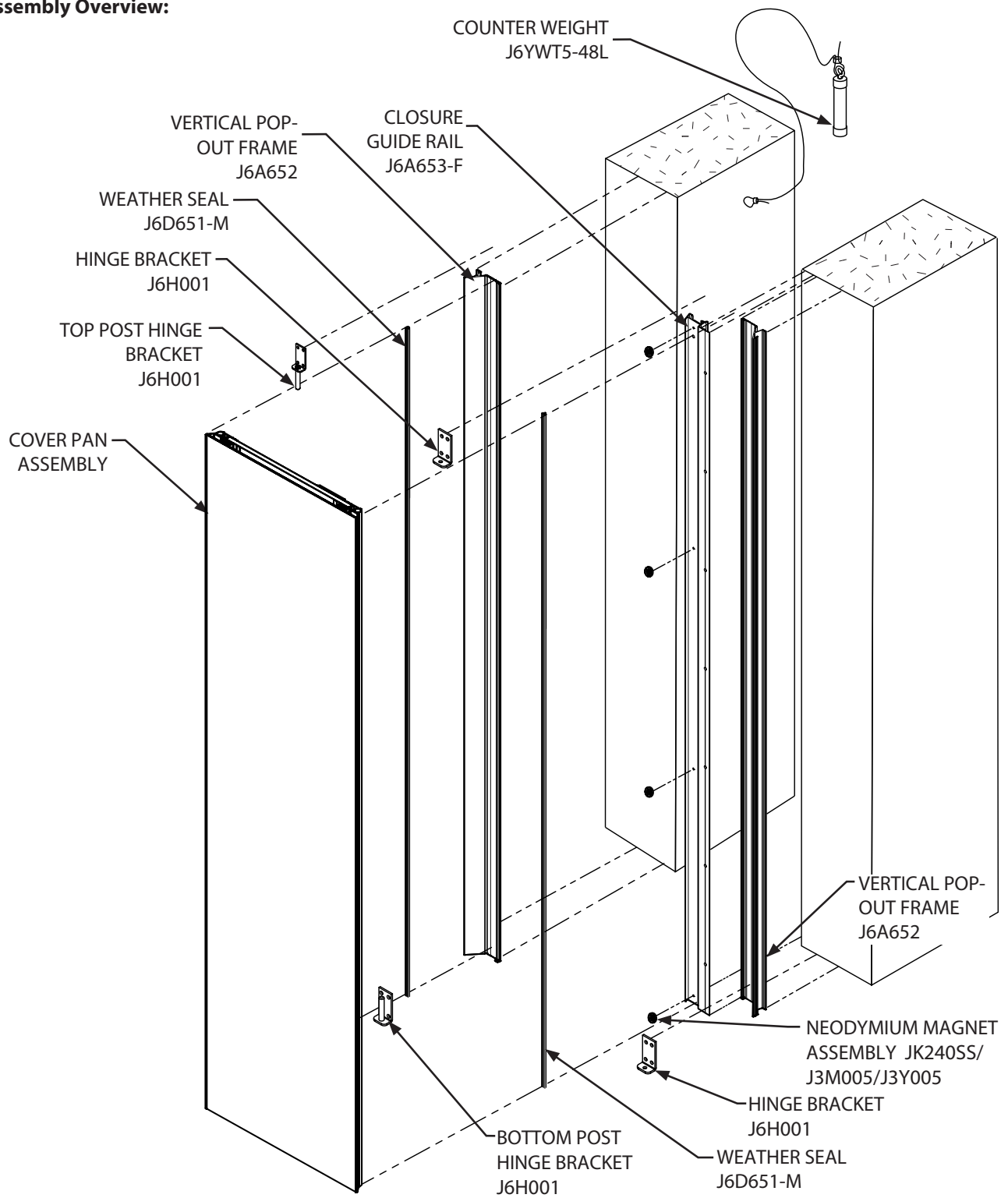

JOINTMASTER® Expansion Joint Systems

[inpro.com](http://inpro.com) • 800.222.5556 • 262.679.9010

World Headquarters S80 W18766 Apollo Drive, Muskego, WI 53150 USA

Installation Hotline: 866.394.6776

**inpro**®

# Installation Instructions

Joint System: 650C-A07 Wall to Wall

## Components:

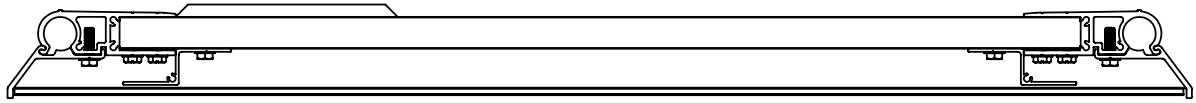

COVER PAN ASSEMBLY

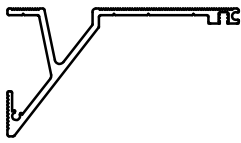

J6A652  
VERTICAL POP-OUT  
FRAME

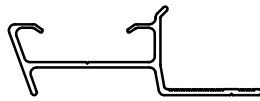

J6A653-F  
CLOSURE GUIDE  
RAIL



JKSS29  
#10-32 x 5/8"  
THREAD FORMING  
SCREW



JK247  
FLAT HEAD SELF-  
DRILLING SHEET  
METAL SCREWS



JK244  
PLASTIC  
GROMMET



J6D651-M  
WEATHER  
SEAL

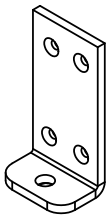

J6H001  
HINGE  
BRACKET

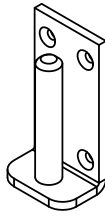

J6H001  
BOTTOM  
POST HINGE  
BRACKET

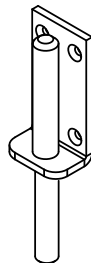

J6H001  
STACKABLE  
POST HINGE  
BRACKET

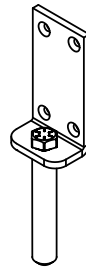

J6H001  
TOP POST  
HINGE  
BRACKET



JK240SS/J3M005/  
J3Y005  
NEODYMIUM  
MAGNET ASSEMBLY

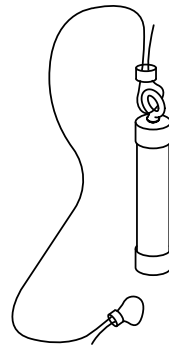

J6YWT5-48L  
COUNTER WEIGHT  
ASSEMBLY

## Required Tools

Saw w/ aluminum cutting blade, Drill with #2 or #3 Phillips, Wire crimper, Compatible sealant to substrate, Safety Glasses, Painters tape, Tape Measure, 2ft to 4ft Level, Plumb bob, Power Drill, Drill Bits (appropriate for surrounding substrate), Circular saw, Power Miter Saw, Fine toothed finish blade for Aluminum

## Exterior Tools

100% silicone (grey), Allen wrench 5/32" [4 mm], Socket 5/16" [8 mm], Channel locks, 5/16" [8 mm] drill bit

JOINTMASTER® Expansion Joint Systems

[inpro.com](http://inpro.com) • 800.222.5556 • 262.679.9010

World Headquarters S80 W18766 Apollo Drive, Muskego, WI 53150 USA

Installation Hotline: 866.394.6776

**inpro**®

# Installation Instructions

## Joint System: 650C-A07 Wall to Wall

### Figure 1 Installing the Frames

1. Install the left vertical pop-out frame 1 1/2" [38mm] from joint edge with flat head self-drilling sheet metal screws (7 per frame) (See Fig.1)
2. Install the closure guide rail flush to right joint edge with flat head self-drilling sheet metal screws (7 per frame) (See Fig.1)
3. Install the right vertical pop-out frame flush to closure guide rail with flat head self-drilling sheet metal screws (7 per frame) (See Fig.1)
4. Continue installation up the wall. Ensure frames are vertically plumb up wall.

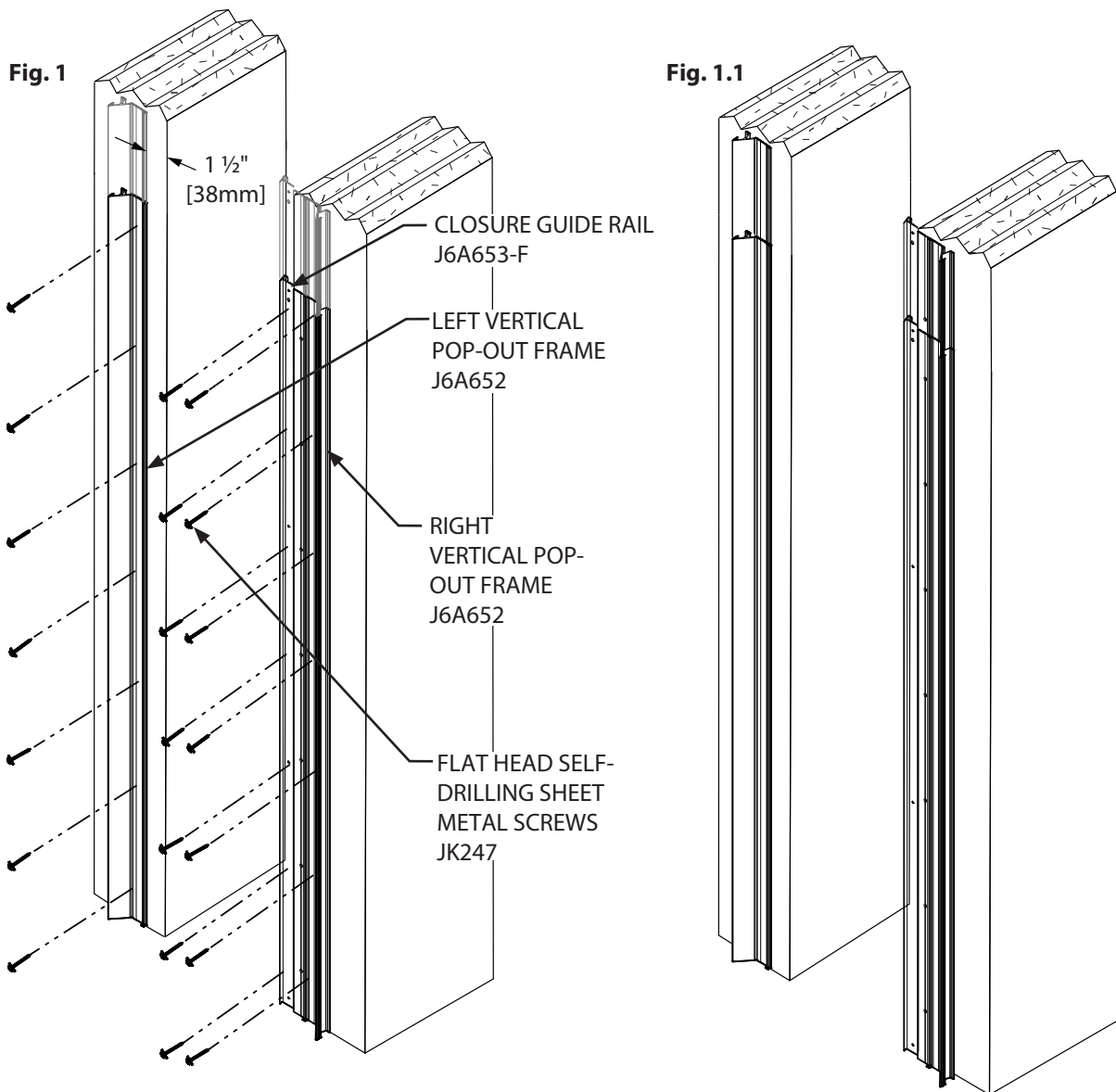

JOINTMASTER® Expansion Joint Systems

[inpro.com](http://inpro.com) • 800.222.5556 • 262.679.9010

World Headquarters S80 W18766 Apollo Drive, Muskego, WI 53150 USA

Installation Hotline: 866.394.6776

**inpro**®

# Installation Instructions

Joint System: 650C-A07 Wall to Wall

## Figure 2 Installing Weather Seals

5. Press weather seals into both vertical pop-out frames up full height of installation. (See Fig.2)

\*NOTE: Spray soapy water into receiving channel for ease of installation.

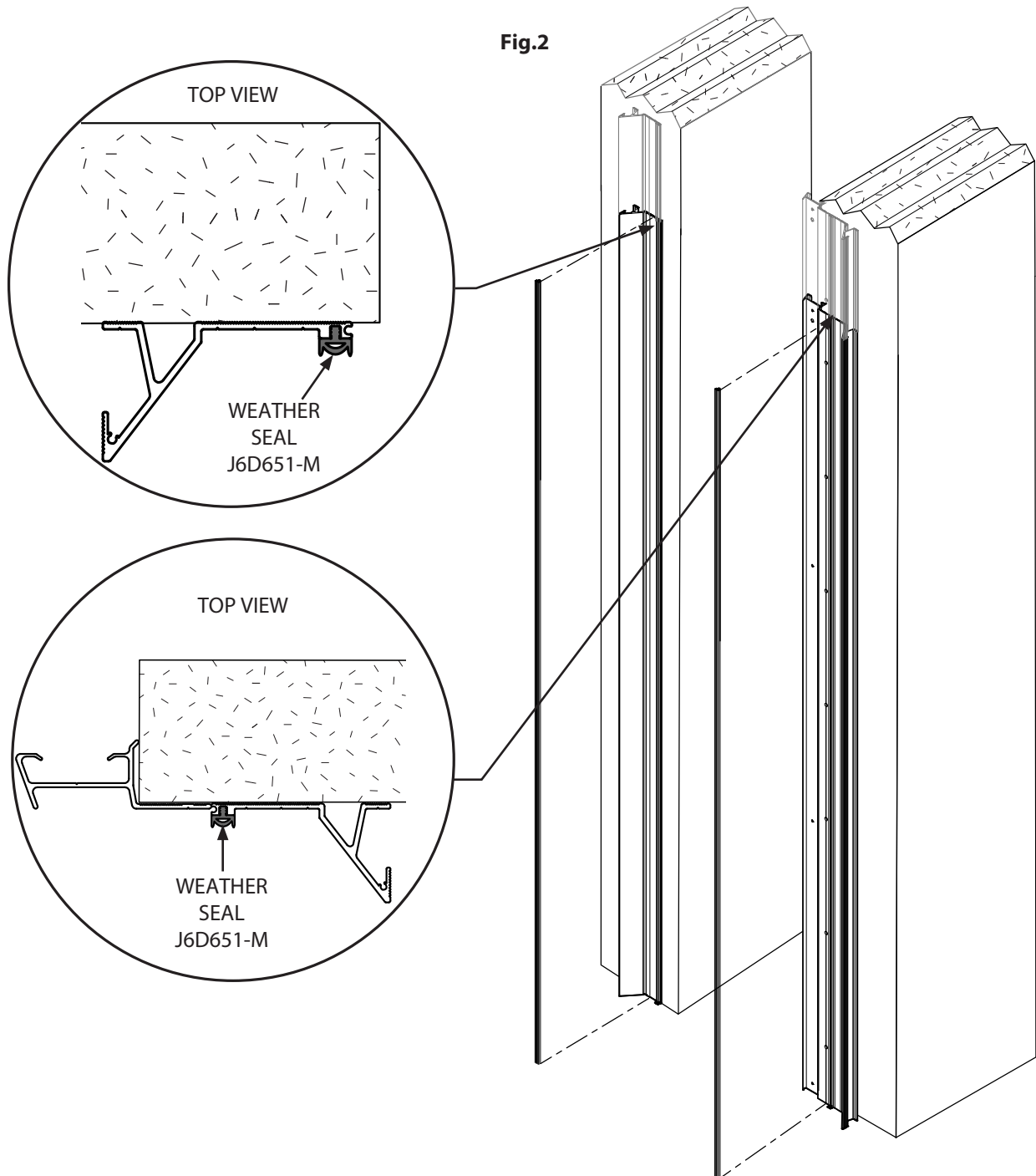

JOINTMASTER® Expansion Joint Systems

[inpro.com](http://inpro.com) • 800.222.5556 • 262.679.9010

World Headquarters S80 W18766 Apollo Drive, Muskego, WI 53150 USA

Installation Hotline: 866.394.6776

**inpro**®

# Installation Instructions

## Joint System: 650C-A07 Wall to Wall

### Figure 3 Installing Hinge Brackets

6. Pre-assemble post hinge brackets before installing to frames. (See Fig.3) **NOTE:** Ensure hinge bolts and rods are seated firmly against lock washer. It is recommended to add red loctite to threads before seating.
7. Locate bottom post hinge bracket so that horizontal leg is flush to bottom hinge to align with the bottom edges of frames. Make hole locations and pre drill. Fasten brackets with flat head self-drilling sheet metal screws.(4 per bracket). (See Fig. 3.1)

Fig. 3

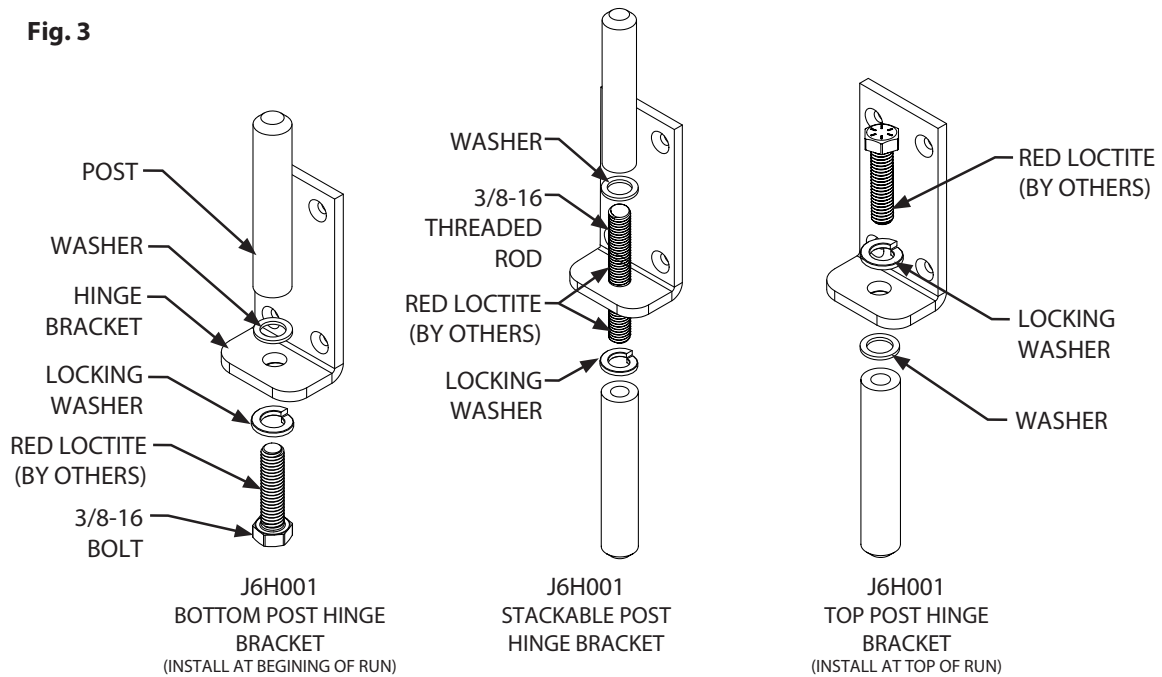
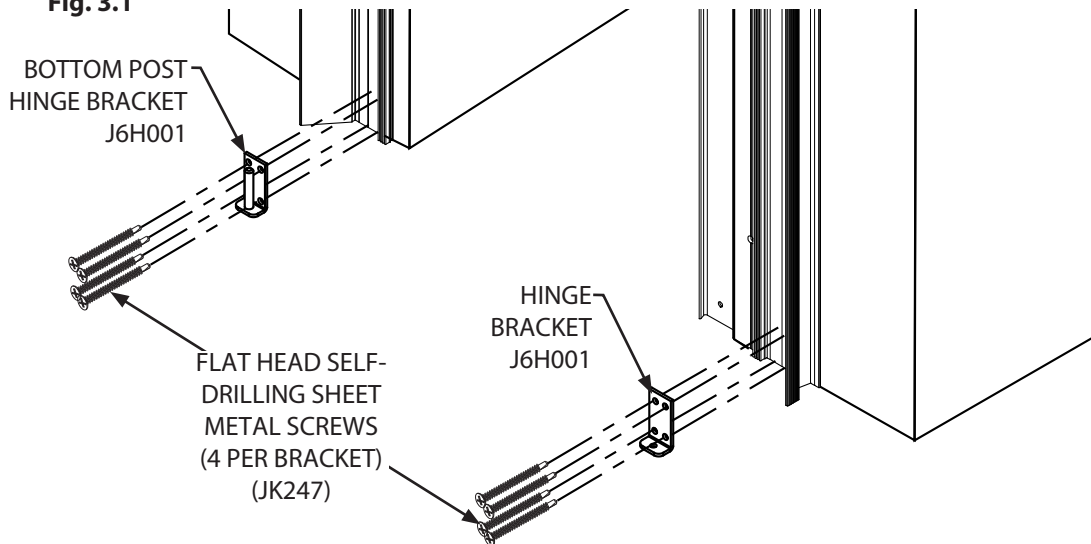

Fig. 3.1



# Installation Instructions

Joint System: 650C-A07 Wall to Wall

## Figure 3 (Continued) Installing Hinge Brackets

8. Measure Cover Pan Assembly height to determine placement of top post hinge bracket OR stackable post hinge bracket, and hinge bracket. (Top post hinge bracket shown) Pre-drill holes at locations. (See Fig.3.2)

NOTE: If cover is last in run, cut pan assembly height to be 3.5" [89mm] from top of frame. (See fig 3.3) (Reference last page for cutting instructions.)

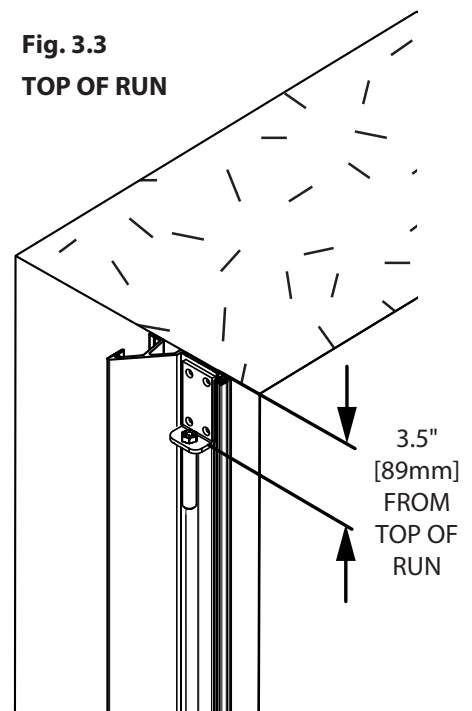
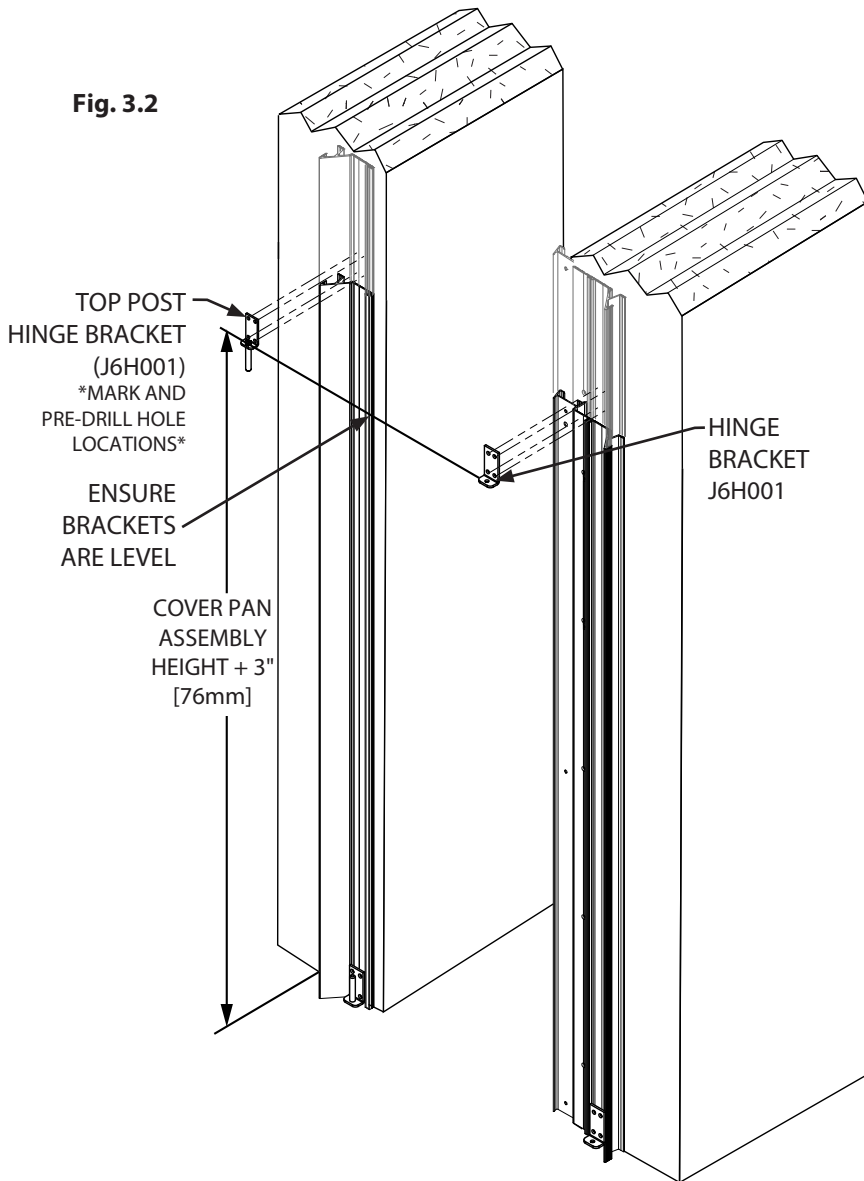

JOINTMASTER® Expansion Joint Systems

[inpro.com](http://inpro.com) • 800.222.5556 • 262.679.9010

World Headquarters S80 W18766 Apollo Drive, Muskego, WI 53150 USA

Installation Hotline: 866.394.6776

**inpro**®

# Installation Instructions

## Joint System: 650C-A07 Wall to Wall

### Figure 4 Installing Neodymium Magnets

9. Install neodymium magnets as shown using JK240SS(x1), J3M005(x1), J3Y005(x2) (4 per frame) Using a 5/32" [4mm] allen wrench. (See Fig.4)
10. Press fit plastic grommet into second hole from top (x1). (See Fig.4) If frame is cut down, drill a new hole for grommet 15/64" [6mm] from top using a 5/16" [8 mm] drill bit.

Fig.4

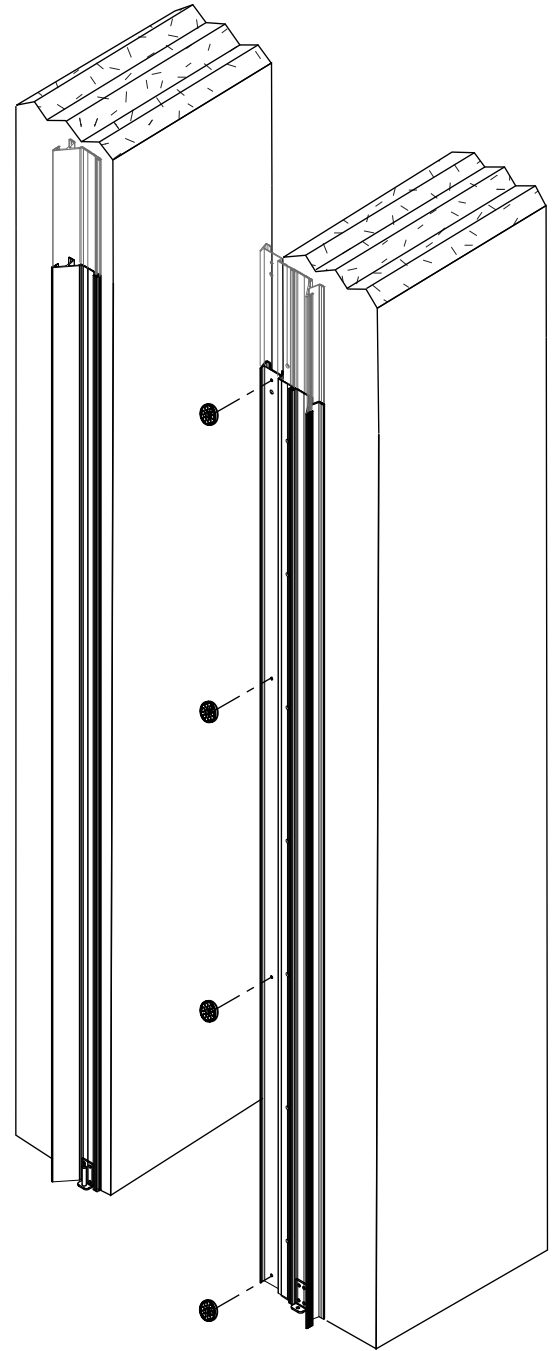
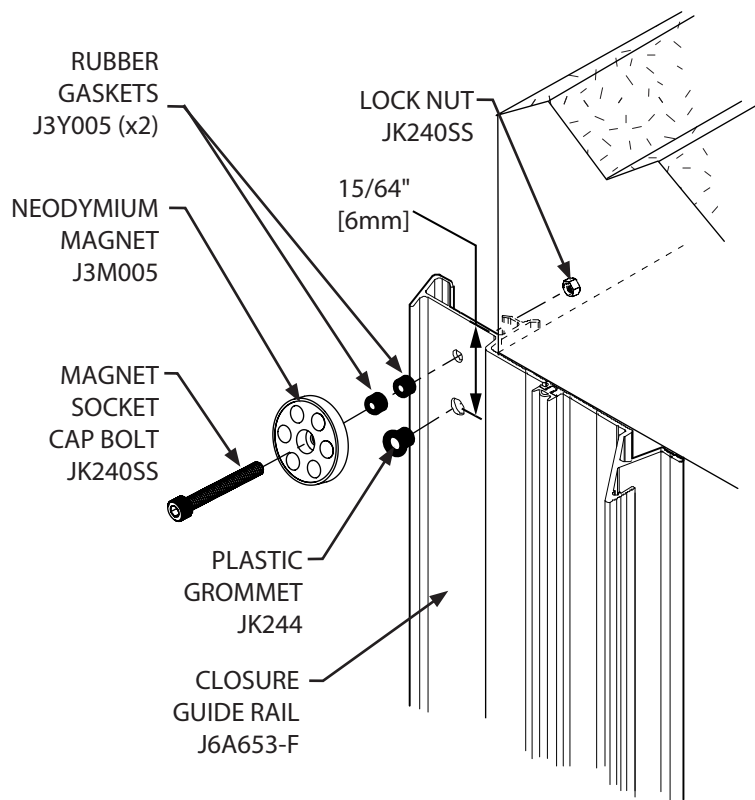

JOINTMASTER® Expansion Joint Systems

[inpro.com](http://inpro.com) • 800.222.5556 • 262.679.9010

World Headquarters S80 W18766 Apollo Drive, Muskego, WI 53150 USA

Installation Hotline: 866.394.6776

**inpro**®



# Installation Instructions

## Joint System: 650C-A07 Wall to Wall

### Figure 5 Installing Counter Weight

11. Insert one end of cable through plastic grommet. (See Fig.5)
12. On front side of closure guide rail, slide a crimp onto cable and create a loop 1/4" - 3/8" diameter. Clamp using crimping tool to secure. (See Fig.5.1)
13. On back side of closure guide rail, slide a crimp onto cable and slide cable through eye bolt on counter weight. Loop cable around eye bolt and back into crimp. Clamp using crimping tool to secure. (See Fig.5 & Fig.5.1)

**NOTE:** DO NOT CRUSH MIDDLE OF CRIMP

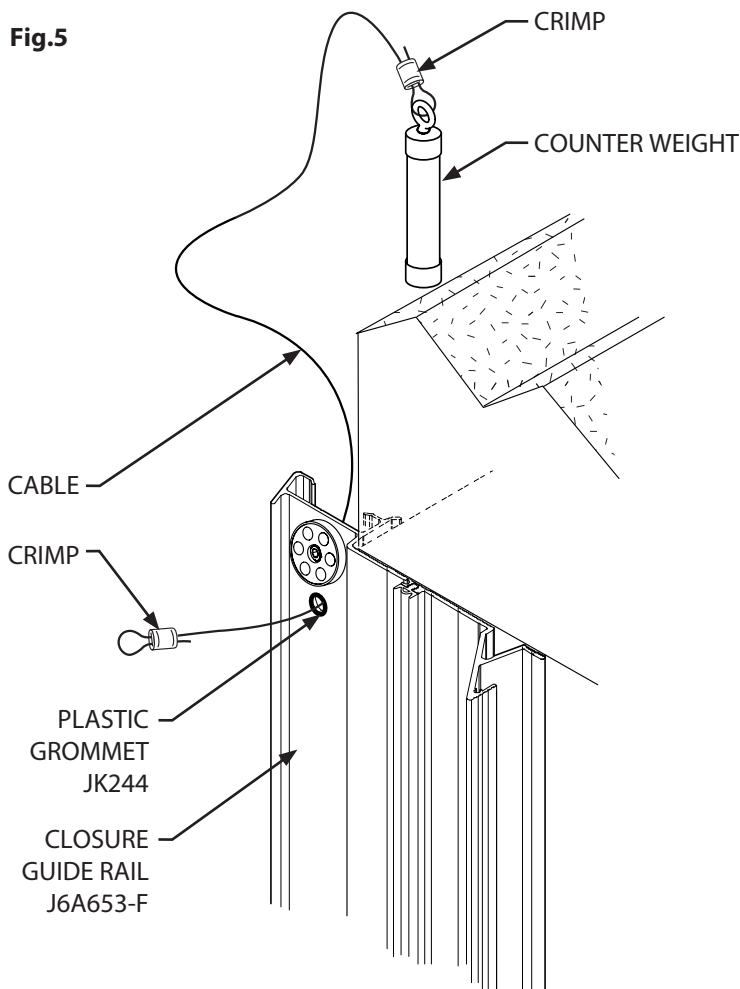

**Fig.5.1**

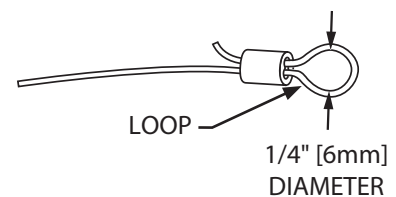

**NOTE:** DO NOT CRUSH MIDDLE OF CRIMP

# Installation Instructions

Joint System: 650C-A07 Wall to Wall

## Figure 6 Installing Cover Pan Assembly

14. Drop cover pan assembly on to bottom post hinge bracket. (See Fig.6)

15. Insert top post hinge bracket OR stackable post hinge bracket into cover pan assembly. (Top post hinge bracket shown) (See Fig.6.1)

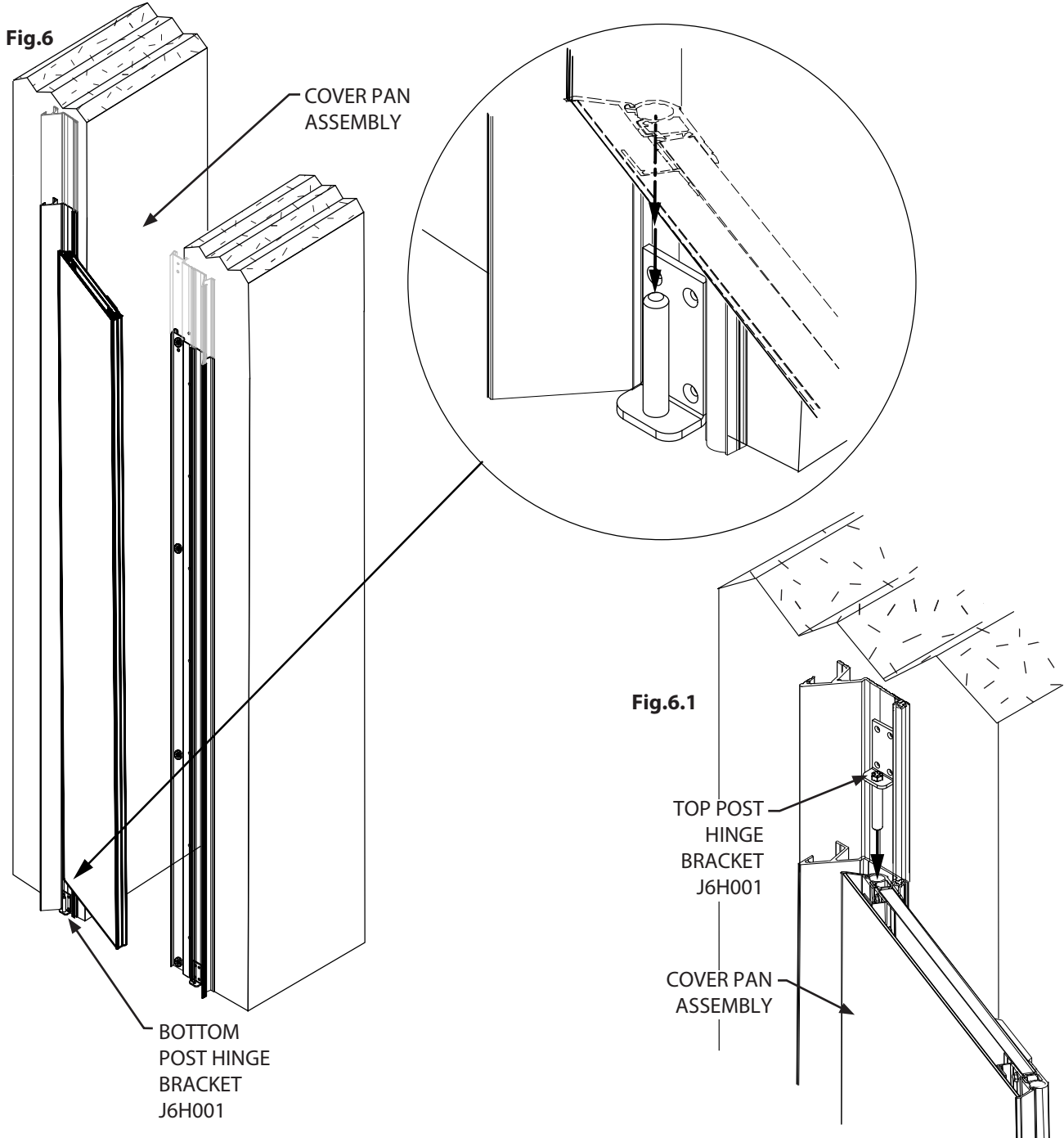

JOINTMASTER® Expansion Joint Systems

[inpro.com](http://inpro.com) • 800.222.5556 • 262.679.9010

World Headquarters S80 W18766 Apollo Drive, Muskego, WI 53150 USA

Installation Hotline: 866.394.6776

**inpro**®

# Installation Instructions

Joint System: 650C-A07 Wall to Wall

## Figure 6 (Continued) Installing Cover Pan Assembly

16. Install post hinge bracket and hinge bracket with flat head self drilling sheet metal screws. Ensure brackets are level across substrates. (4 per bracket) (See Fig 6.2)

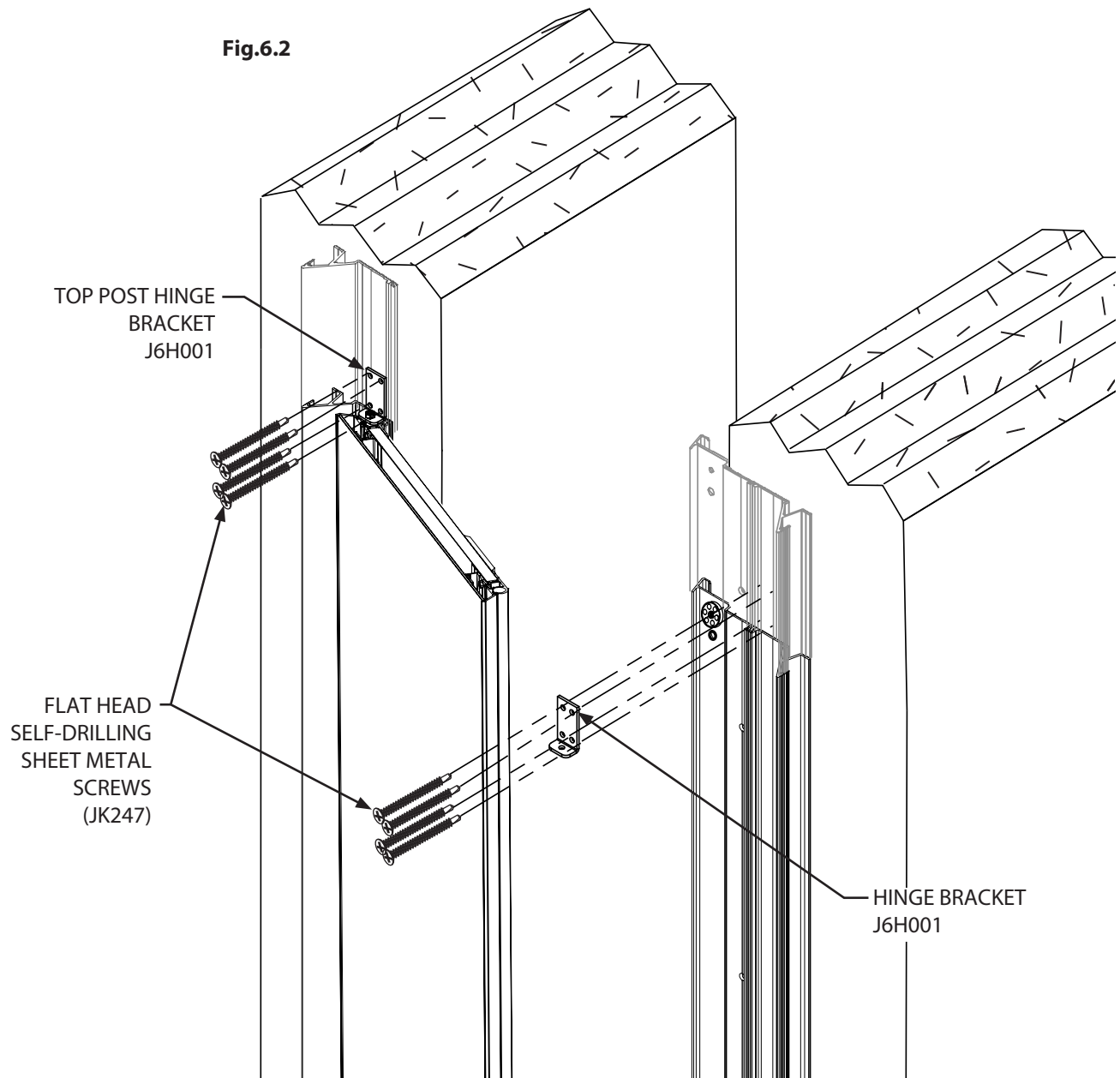

JOINTMASTER® Expansion Joint Systems

[inpro.com](http://inpro.com) • 800.222.5556 • 262.679.9010

World Headquarters S80 W18766 Apollo Drive, Muskego, WI 53150 USA

Installation Hotline: 866.394.6776

**inpro**®

# Installation Instructions

Joint System: 650C-A07 Wall to Wall

## Figure 7 Connecting the Counter Weight Assembly

17. Connect counter weight cable to the cover pan assembly.
18. Pre-drill and fasten #10-32x $\frac{5}{8}$ " thread forming hex head screw to underside of top horizontal rung in line with center screw on strike plate, looping counter weight cable over screw. (See Fig.7 & Fig.7.1)

Fig.7

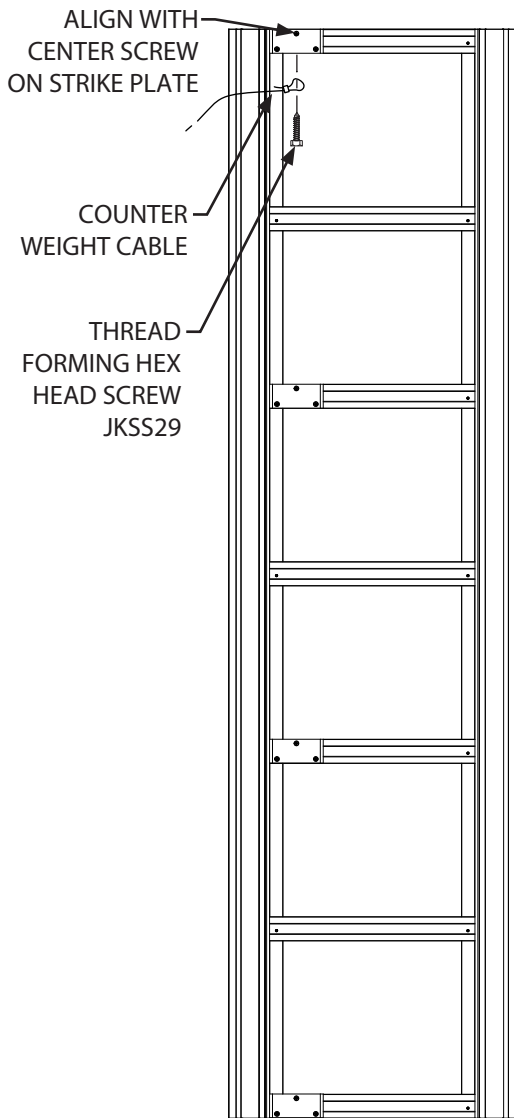

BACK VIEW OF COVER PAN ASSEMBLY

Fig.7.1

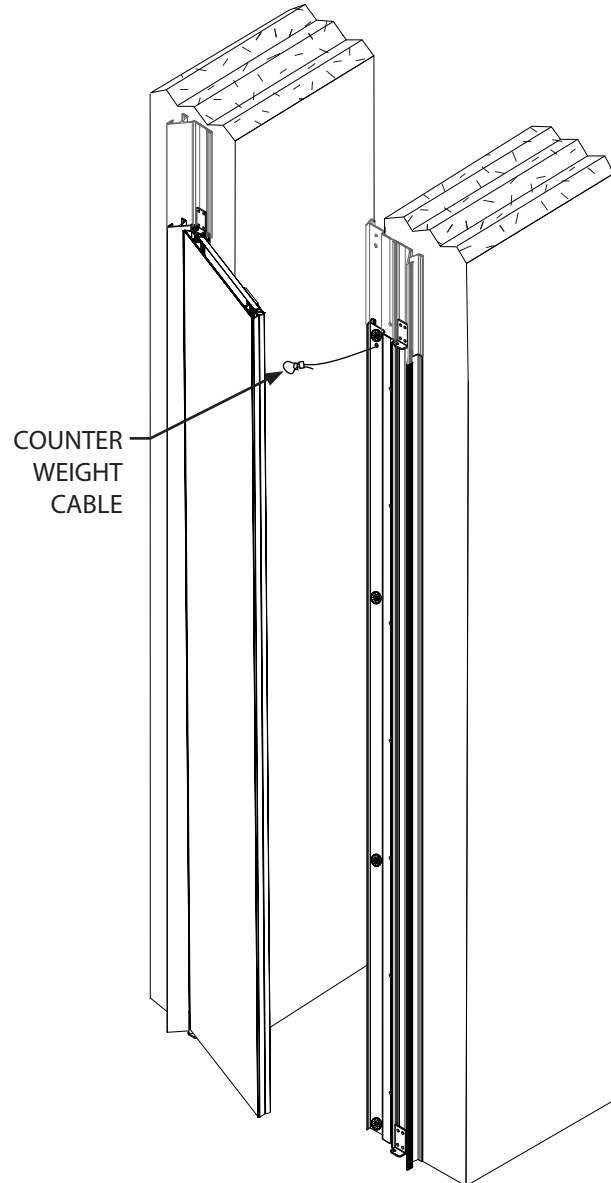

JOINTMASTER® Expansion Joint Systems

[inpro.com](http://inpro.com) • 800.222.5556 • 262.679.9010

World Headquarters S80 W18766 Apollo Drive, Muskego, WI 53150 USA

Installation Hotline: 866.394.6776

**inpro**®

# Installation Instructions

## Joint System: 650C-A07 Wall to Wall

### Figure 8 Installing Splice Plate

19. Attach splice plate to back of panel on cover pan assembly with GPH tape. Be sure to clean any debris off of the back of panel before adhering. (See Fig.8.1)
20. Steps 1-6 should be completed up entire wall before installing cover pans. Continue installation of cover pans repeating steps 6-19.

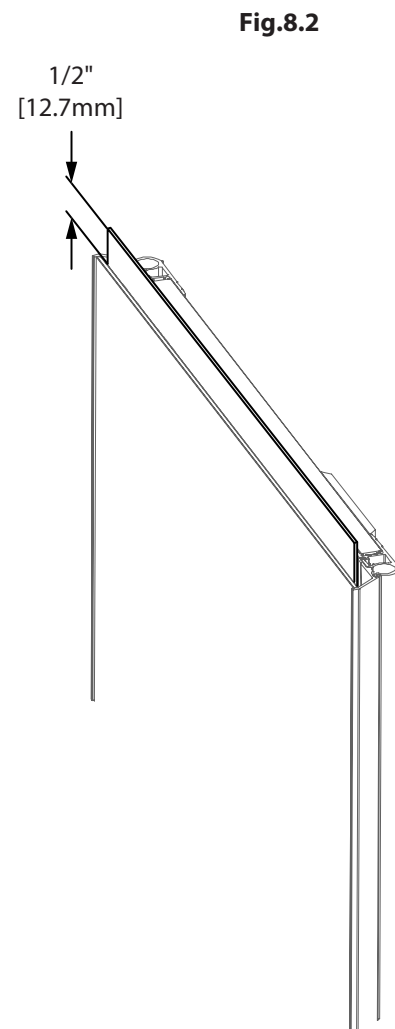
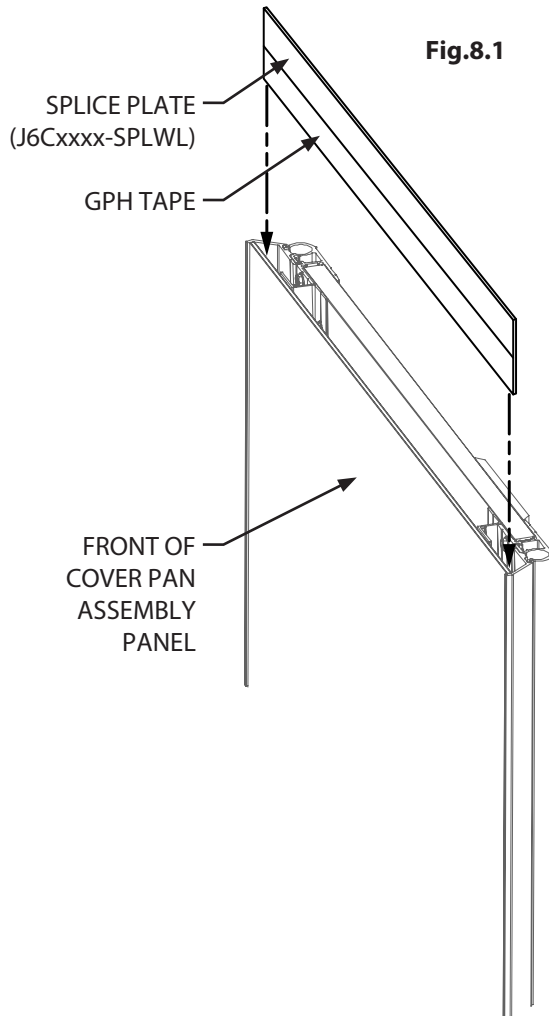

# Installation Instructions

## Joint System: 650C-A07 Wall to Wall

### Figure 9 Cutting Pan Assembly

21. Measure out length of the final section of run. (See Fig.9.1)
22. Deduct the bracket (J6H001) height from length (3.5" [89mm]). (See Fig.9.1)
23. Protect the face of the system by applying masking or painter's tape to the area of the cut. Use a T square or other straight edge to mark the cut line on the tape. Ensure the line is perpendicular to the sides of the pan. (See Fig.9.1)

**Note: If the cut line is in line with a horizontal strut of the frame system. Remove the horizontal strut before cutting the pan.**

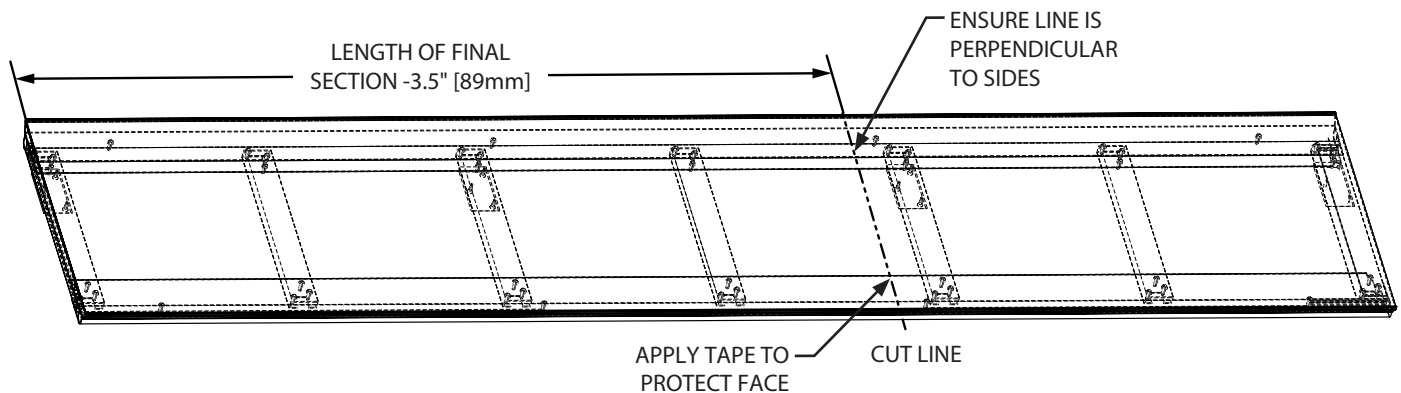

24. After completing the cut, remove the tape, and deburr any sharp edges around the frame with a metal file. (See Fig 9.2)
25. \*\*If the cut removed one of the green magnetic strike plates, remove the horizontal strut with the strike plate, and install flush to end of cut edge. (See Fig 9.2)

**Note: install cut pan with cut edge up. (Installing pan with cut side down will not allow transition strip to sit behind cover sheet)**

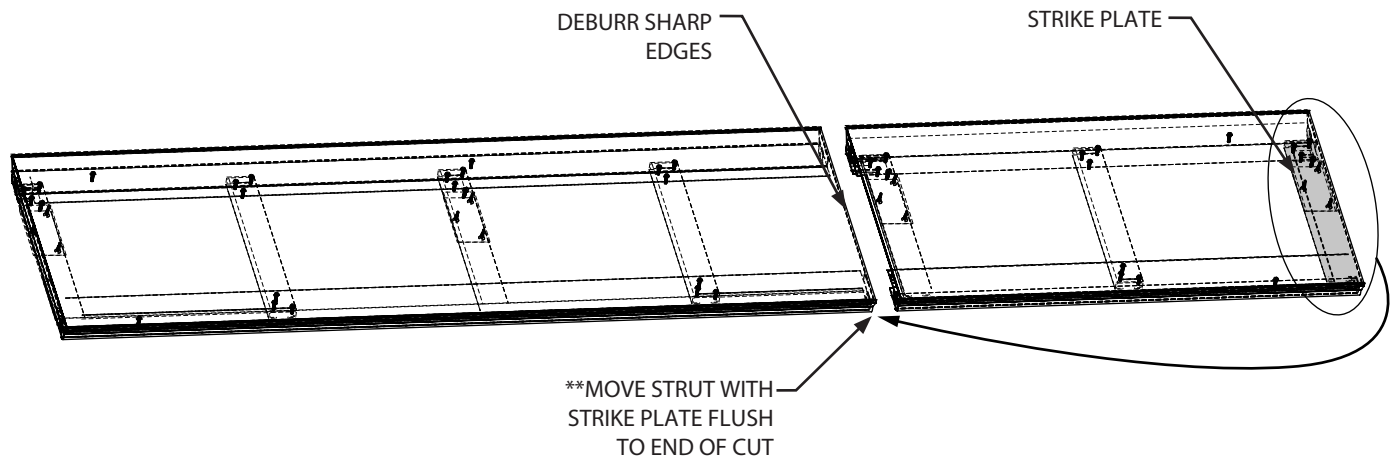

JOINTMASTER® Expansion Joint Systems

inpro.com • 800.222.5556 • 262.679.9010

World Headquarters S80 W18766 Apollo Drive, Muskego, WI 53150 USA

Installation Hotline: 866.394.6776

**inpro**®