

#8 X 2" [M4 x 50 SELF-TAPPING SHEET METAL SCREW (7 PER FRAME @ 18" [457mm] O.C.) (JK061)

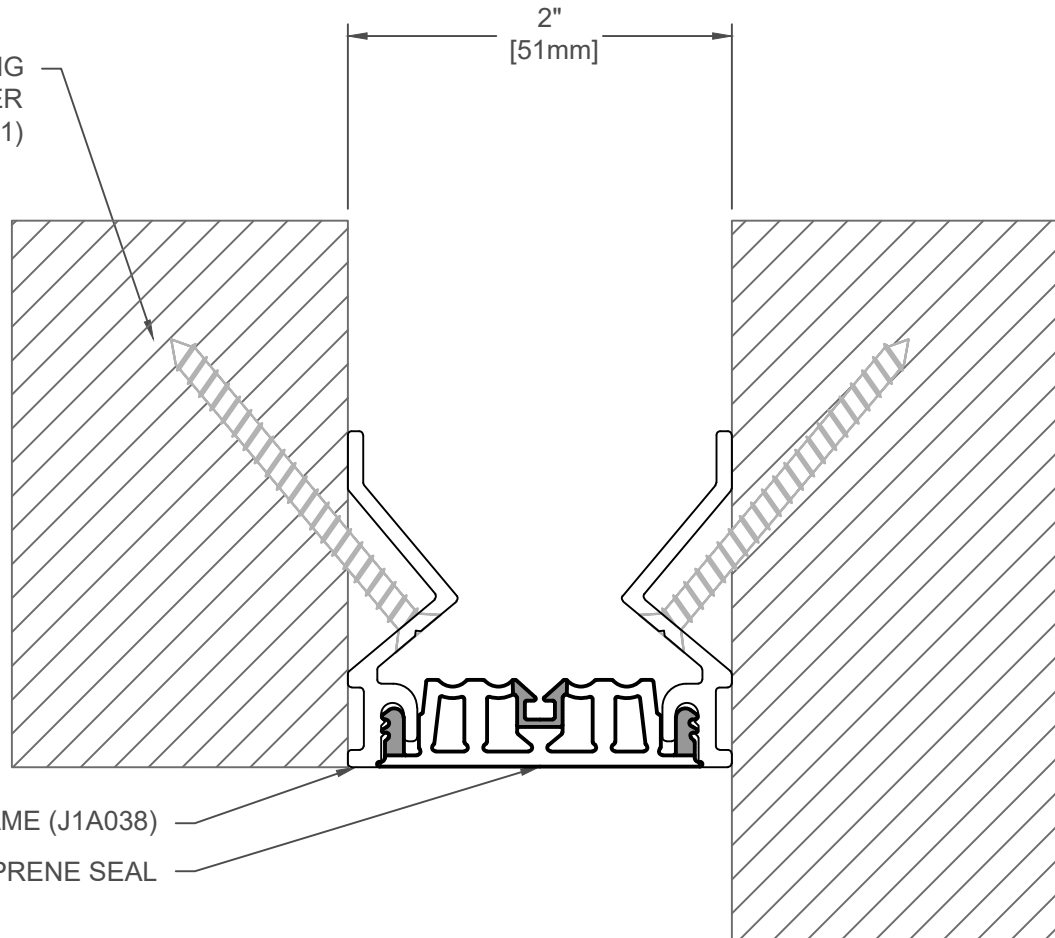

CONT. ALUM. FLUSH WALL FRAME (J1A038)

CONT. SANTOPRENE SEAL

**SPECIFY SEAL COLOR:**

Black (J1D201)	
Beige (J1D202)	
Gray (J1D203)	
Off White (J1D204)	
Bright White (J1D205)	
Greige (J1D206)	

**118-A09-050**

JOINT WIDTH		MOVEMENT ±			
		HORIZONTAL		VERTICAL	
US	mm	US	mm	US	mm
2"	51	1/2"	13	1/2"	13

FINISH: ALUM. FINISH-MILL
PROJECT:
CUSTOMER:
LOCATION:

APPLICATION-  
FLUSH MOUNT WALL/CORNER-WALL/CEILING CONDITION

DATE:	03-03-17
SCALE:	1:1
DOC:	CADJM.084/R3



For More Information Visit: [Inprocorp.com](http://Inprocorp.com)

#8 X 2" [M4 x 50  
SELF-TAPPING SHEET  
METAL SCREW (7 PER  
FRAME @ 18" [457mm]  
O.C.) (JK061)

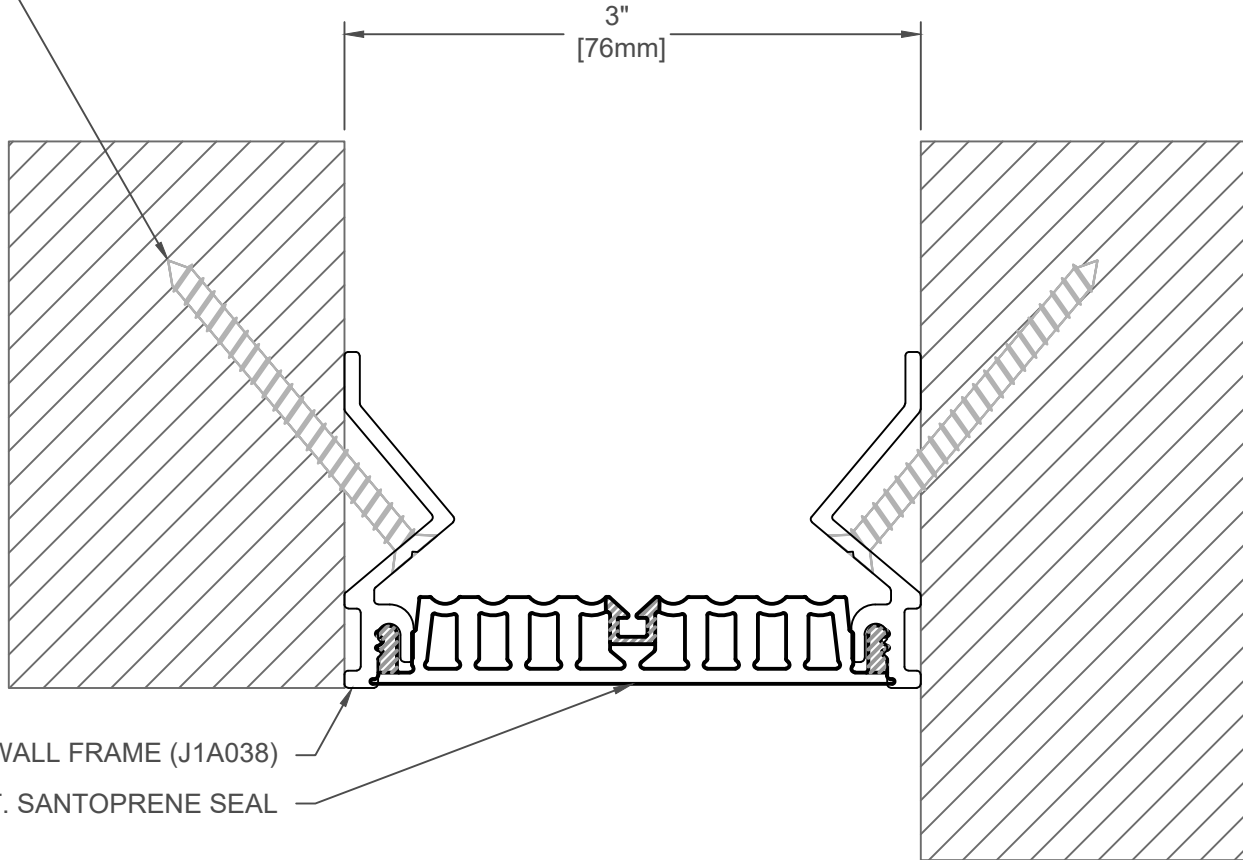

CONT. ALUM. FLUSH WALL FRAME (J1A038)

CONT. SANTOPRENE SEAL

SPECIFY SEAL COLOR:	
Black (J1D301)	
Beige (J1D302)	
Gray (J1D303)	
Off White (J1D304)	
Bright White (J1D305)	
Greige (J1D306)	

118-A09-075

JOINT WIDTH		MOVEMENT ±			
		HORIZONTAL		VERTICAL	
US	mm	US	mm	US	mm
3"	76	3/4"	19	3/4"	19

FINISH: ALUM. FINISH-MILL

PROJECT:

CUSTOMER:

LOCATION:

APPLICATION-  
FLUSH MOUNT WALL/CORNER-WALL/CEILING CONDITION

DATE: 03-03-17

SCALE: 1:1

DOC: CADJM.084/R3

**inpro.**

For More Information Visit: [Inprocorp.com](http://Inprocorp.com)