

106 Series Surface Mount

A01 - Floor to Floor

A02 - Floor to Wall

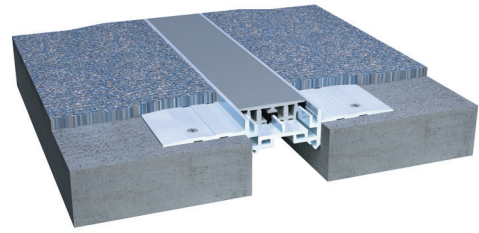

Movement Rating \pm 25%

Product Guide



Thermal



Interior



Fire Rated Option



Vapor Barrier Option



ADA Compliant

- ▶ Dual durometer seal provides secure fit and optimal flexibility
 - ▶ Seals absorb limited serviceable seismic movement
 - ▶ Designed for renovation and surface mount installations
 - ▶ Adaptable to concrete, epoxy, vinyl and caret finishes
 - ▶ Seamlessly integrates with the following wall and ceiling systems
 - ▶ Easy to clean flush seals. No dirt or water traps
 - ▶ Snap-fit design for easy on site assembly
 - ▶ Mill finish aluminum
- ▶ Standard and Custom seal colors available.
 - All seals achieve UL Environmental Greenguard Gold Certification for ultra low VOC's

Application	System	W		H1		H2		S		B		Movement +/-			
		Joint Width		Frame Height 1		Height 2		Sightline		Blockout		Horizontal		Vertical	
		US	mm	US	mm	US	mm	US	mm	US	mm	US	mm	US	mm
Floor to Floor	106-A01-025	1"	25	5/8"	16	1/4"	6	1"	25	*	*	1/4"	6	1/4"	6
	106-A01-038	1 1/2"	38	5/8"	16	1/4"	6	1 1/2"	36	*	*	3/8"	10	3/8"	10
	106-A01-050	2"	51	1"	25	1/4"	6	2"	47	*	*	1/2"	13	1/2"	13
	106-A01-075	3"	76	1 1/8"	28	1/4"	6	3"	73	*	*	3/4"	19	3/4"	19
Floor to Wall	106-A02-025	1"	25	5/8"	16	1/4"	6	1"	25	*	*	1/4"	6	1/4"	6
	106-A02-038	1 1/2"	38	5/8"	16	1/4"	6	1 1/2"	36	*	*	3/8"	10	3/8"	10
	106-A02-050	2"	51	1"	25	1/4"	6	2"	47	*	*	1/2"	13	1/2"	13
	106-A02-075	3"	76	1 1/8"	28	1/4"	6	3"	73	*	*	3/4"	19	3/4"	19

IPC.653/REV.6

106 Series

Surface Mount Floor Systems

106-A01 Floor/Floor for Carpet
(2" (50mm) system shown)

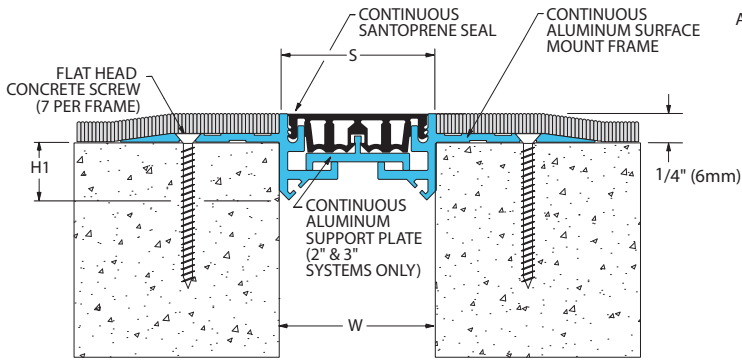

106-A02 Floor/Floor for Carpet
(2" (50mm) system shown)

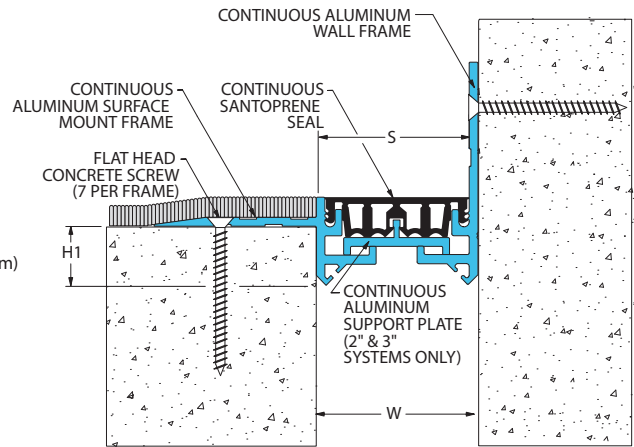

106 Series

Options

Fire Mineral Wool & Sealant Fire Barrier System
(106-A01-025 system shown)

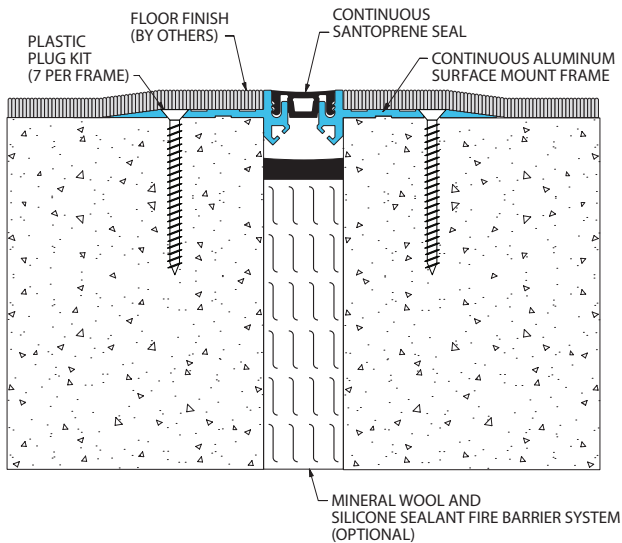

Vapor Barrier System
(106-A01-50 system shown)

